

# Neumo Ehrenberg Group

NEUMO · EGMO · AWH · RIEGER · VNE · HERRLI



## SANITARY STAINLESS STEEL

Fittings & Valves Catalogue



ISO 9001:2000 Certified

# Neumo Ehrenberg Group

Sanitary Stainless Steel



## The Neumo Ehrenberg Group - Global Locations





## Fittings & Valves

**EGMO** develops, designs, manufactures and markets a wide range of hygienic Stainless Steel tubular and machined fittings for the chemical, dairy and food industries for 40 years.

**EGMO is ISO 9001:2000 certified**, and its products also meet the following standards:

- **3A:** American standard (Food and Dairy).
- **DIN:** DIN 11851/11852 standards.
- **BS/RJT:** British Standard 4825 pa.5.



- **ISO:** International Standardization Organization Standard.

- **SMS:** Swedish Milk Standard.

- **IDF:** International Dairy Federation standard.

- **DS:** Danish Standard.

**EGMO** is a world-leading supplier of installation material for a wide range of sanitary applications including food, dairy, winery and beverage. Our products are developed not only to meet your exact demands for safety, efficiency and hygiene, but also to ensure the careful handling of your products.



**We can offer you high-quality sanitary installation material:**

- Unions and Clamp fittings
- Tubular fittings: Bends, Tees & Reducers
- Valves & Actuators
- Tubing

**EGMO** offers installation material in various standards. So you can always find the right part, with the process quality you need, for your specific application.





### INDEX:

■ EGMO Sanitary Stainless Steel Fittings Specifications .....	Page 1
■ Fittings Ordering Information .....	Page 2
■ 3A .....	Page 3 - 12
■ DIN .....	Page 13 - 19
■ BS .....	Page 20 - 23
■ SMS .....	Page 24 - 26
■ Valves & Actuators .....	Page 27 - 36
■ Accessories .....	Page 37 - 41
■ EGMO Customized Components .....	Page 42
for Dairy & Food Industry	
■ Technical Information .....	Page 43 - 46
■ The Neumo-Ehrenberg Group - Global Locations .....	Page 47



**EGMO Sanitary Stainless Steel Fittings Specifications**

■ **Product range:**

- DIN
- ISO
- 3A Clamp and weld ends fittings
- 3A Bevel seat fittings
- SMS
- BS (RJT)
- IDF - per request
- DS - per request
- Tube OD sizes range: 1" - 4" / DN 25-100 as standard; additional sizes are available upon request

■ **Dimensions and Tolerances:**

Wall thickness tolerances are set and maintained to match-up ASTM A269/270 requirements. After forming, all tubular fittings undergo a resizing operation to ensure dimensional accuracy before facing and finishing operations. The sizing technique employed varies according to the shape and dimension of the specific fitting.

■ **Controlled Metallurgy:**

- Excellent batch-to-batch consistency leads to excellent consistency of orbital welds.

■ **Surface finish:**

EGMO offers a wide variety of surface finishing according to Table - FS:

- Mechanically polished
- Tumbled
- Shot peened
- Electro-polished - special on request

■ **Cleaning:**

All EGMO stainless steel parts are passivated in a light acid solution to ensure that components are free of contaminants such as burrs, stains, oil, loose particles etc. At a final stage, the fittings are double-rinsed using hot DI water.

■ **Marking:**

Each fitting is marked to show the following:

- Material type.
- Manufacturer's brand.
- 3A symbol (if applicable).
- Product size.
- Heat No.
- Job No.

**Note:**

In some instances, due to the size of the component, this information may be presented in the form of a code.

■ **Packaging:**

Each fitting is bagged or skin-packed on cardboard.

■ **Documentation:**

Full Material Test Reports (MTRs) are furnished on customer request with the finished goods, or via interactive internet website, using a special private code.

■ **EGMO Tubular Fittings Surface Finish - Table - FS**

EGMO Surface Finish Code	Inside Surface	Outside Surface
	Surface Treatment	Surface Treatment
1	Unpolished	Unpolished
2	Tumbled	Tumbled
B	Fine Tumbled	Fine Tumbled
F	Mirror Tumbled	Mirror Tumbled
3	Unpolished	Mechanically Polished
4	Fine Tumbled	Mechanically Polished
7	Mechanically Polished to 32 Ra µ-in	Mechanically Polished
S	Shot Peened	Shot Peened

\* Catalogue dimensions are in mm.

\* Subject to change without prior notice.



# Neumo Ehrenberg Group

Sanitary Stainless Steel

## Fittings Ordering Information

Weld fittings and Clamp fittings are available in type AISI 304L (1.4306) and AISI 316L (1.4404) Stainless Steel. These fittings are available in a variety of ID and OD surface finishing, each identified by a code (See table FS).

Instructions for ordering are as follows:

**Specify complete part name including standard, size, surface finish, and material type.**

### Ordering Number Example:

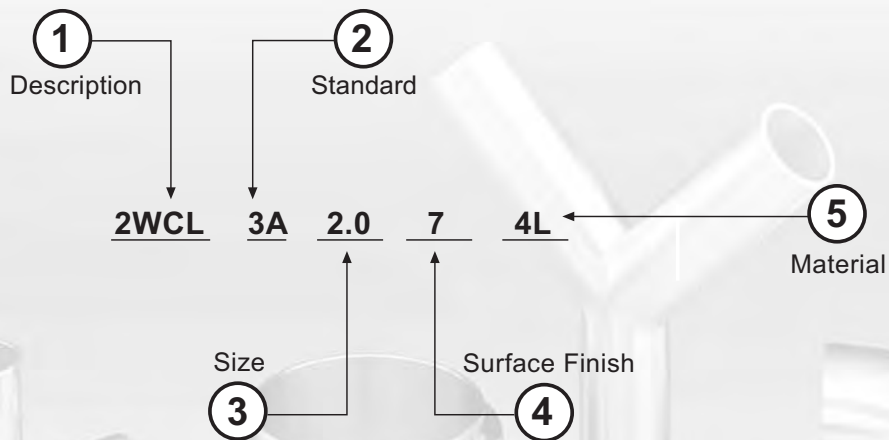

**2 W C L 3 A 2 . 0 7 4 L**

90° elbow short tangent, 3A standard, 2" size, 7-OD&ID surface finish, 304L material.

ORDERING INFORMATION



# 3A

The modern concept of the 3A sanitary standard was established in 1944 when the Surgeon General of the United States Public Health Service/FDA, and the Chairman of the Sanitary Standards Subcommittee of the Dairy Industry's five national trade associations committed to full cooperation with the 3A program. The purpose of the 3A Sanitary Standard is to formulate design criteria to cover a single piece of equipment relating to accepted practices by users, equipment manufacturers and the International Association of Milk, Food and Environmental Sanitarians. Once the 3A Sanitary Standard becomes effective for a manufacturer's selected equipment, authorization to use the 3A Standard symbol comes from eight board members of the Dairy Industry Council, the Dairy and Food Industry Association and the International Association and the International Association of Milk, Food and Environment Sanitarians. The use of the symbol assures processors that the equipment meets sanitary standards, provides accepted sanitary designs and establishes uniform guideline by sanitarians.

### **Weld fittings:**

Weld fittings are offered for 3A standard in nominal tube sizes ½" through 4", in AISI 304L (1.4306) and AISI 316L (1.4404) materials. Uniform wall thickness measures: ASTM A-269/270 1"-3" 0.065" (1.65 mm), 4" 0.083" (2.11 mm).

### **Clamp fittings:**

EGMO offers Clamp fittings in AISI 304L (1.4306) and AISI 316L (1.4404) materials in ½" through 4" sizes. Gaskets for clamp fittings are available in several different materials, Buna-N, EPDM, SILICON®, PTFE® and Viton®. Lightweight and heavy-duty clamps complete the fittings.

### **Bevel seat fittings:**

Bevel seat fittings are used in process equipment and piping to ensure rigidity of the system. Bevel Seat Unions consist of a threaded bevel ferrule mated with plain bevel ferrule. Both are offered in AISI 304L (1.4306) and AISI 316L (1.4404) materials. Gaskets for EGMO's bevel seat unions are not required for positive shut-off. However, gaskets can purchase upon request. EGMO's bevel seat fittings meet all 3A requirements and are available in 1" through 4" sizes.

### **Tubing:**

Tubing is offered ½" through 4" in AISI 304L (1.4306) and AISI 316L (1.4404) stainless steel. A variety of surface finish combinations are available: mill finished, mechanically polished and electropolished according to ASTM A-269/270 standards.

### **Customized components:**

EGMO manufactures products to your specific needs with one of the shortest lead times in the industry.

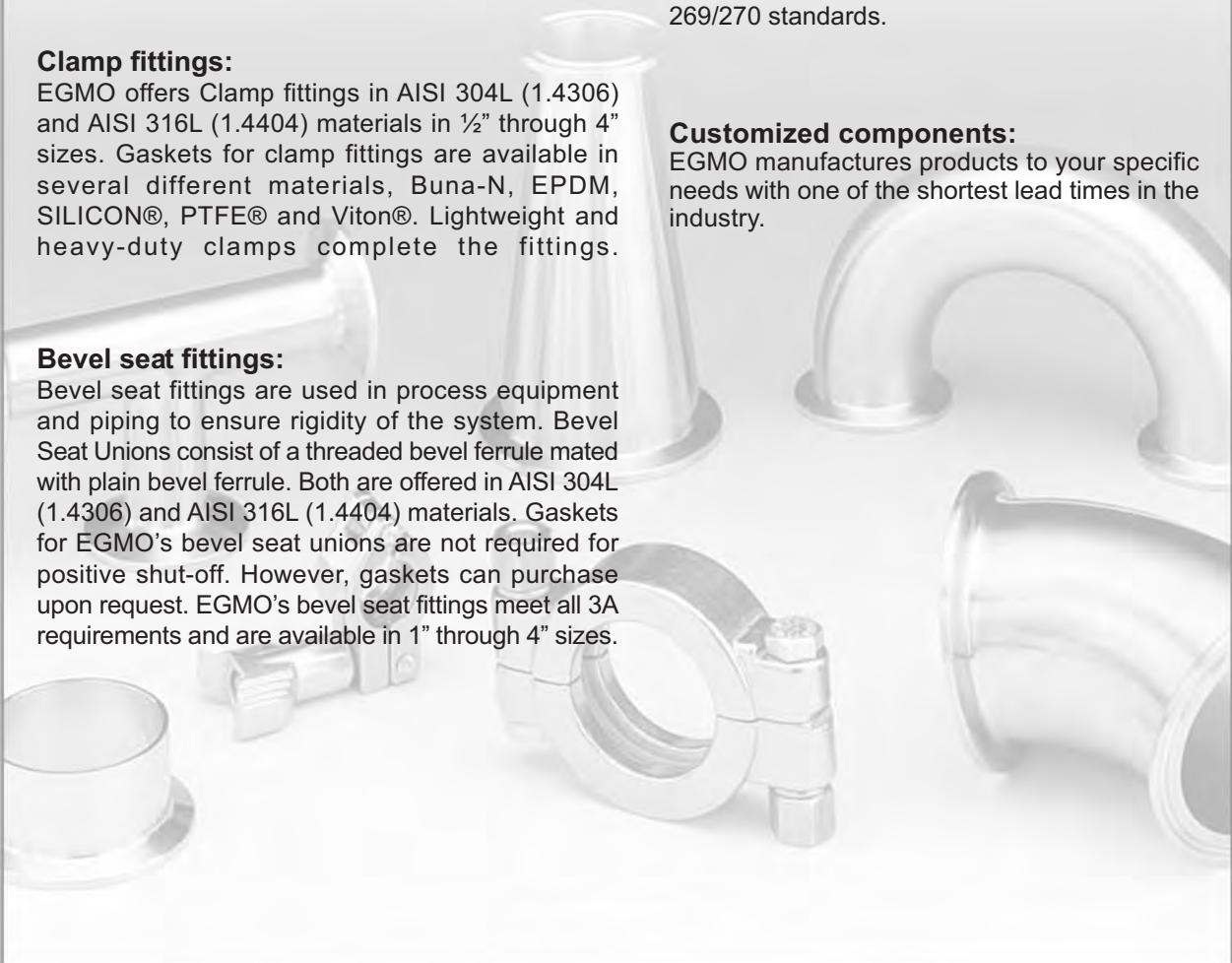



### 2WCL - 3A - 90° ELBOW SHORT TANGENT

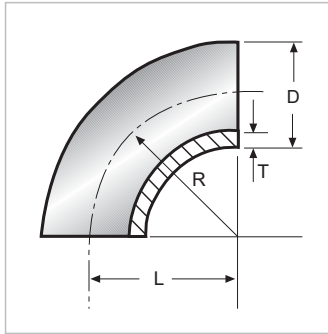

Ordering Code	Size	Dimensions			
		D	T	R	L
2WCL3A1.04L	1"	25.4	1.65	38.1	38.1
2WCL3A1½4L	1½"	38.1	1.65	57.2	57.2
2WCL3A2.04L	2"	50.8	1.65	76.2	76.2
2WCL3A2½4L	2½"	63.5	1.65	95.3	95.3
2WCL3A3.04L	3"	76.2	1.65	114.3	114.3
2WCL3A4.04L	4"	101.6	2.1	152.4	152.4

### E2S - 3A - 90° ELBOW LONG TANGENT

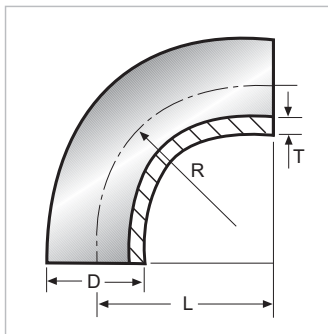

Ordering Code	Size	Dimensions			
		D	T	R	L
E253A1.04L	1"	25.4	1.65	38.1	52.38
E253A1½4L	1½"	38.1	1.65	57.2	74.60
E253A2.04L	2"	50.8	1.65	76.2	103.18
E253A2½4L	2½"	63.5	1.65	95.3	131.75
E253A3.04L	3"	76.2	1.65	114.3	160.27
E253A4.04L	4"	101.6	2.11	152.4	211.07

### E2WK - 3A - 45° ELBOW SHORT TANGENT

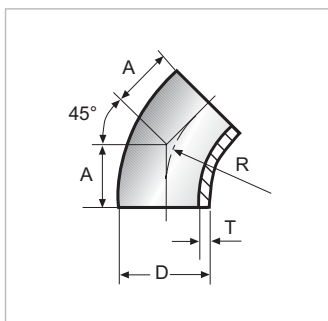

Ordering Code	Size	Dimensions			
		D	T	R	A
E2WK3A1.04L	1"	25.4	1.65	38.1	15.9
E2WK3A1½4L	1½"	38.1	1.65	57.2	23.8
E2WK3A2.04L	2"	50.8	1.65	76.2	31.8
E2WK3A2½4L	2½"	63.5	1.65	95.3	39.7
E2WK3A3.04L	3"	76.2	1.65	114.3	47.6
E2WK3A4.04L	4"	101.6	2.1	152.4	63.5

### E2KS - 3A - 45° ELBOW LONG TANGENT

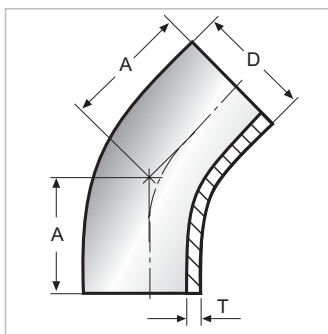

Ordering Code	Size	Dimensions		
		D	T	A
E2KS3A1.04L	1"	25.4	1.65	30.15
E2KS3A1½4L	1½"	38.1	1.65	41.30
E2KS3A2.04L	2"	50.8	1.65	58.70
E2KS3A2½4L	2½"	63.5	1.65	76.20
E2KS3A3.04L	3"	76.2	1.65	93.70
E2KS3A4.04L	4"	101.6	2.11	122.20



### E7WWW - 3A - TEE

Ordering Code	Size	Dimensions			
		D	T	L	I
E7WWW3A1.04L	1"	25.4	1.65	57.2	28.6
E7WWW3A1½4L	1½"	38.1	1.65	84.1	42.1
E7WWW3A2.04L	2"	50.8	1.65	104.8	52.4
E7WWW3A2½4L	2½"	63.5	1.65	117.5	58.8
E7WWW3A3.04L	3"	76.2	1.65	131.8	65.9
E7WWW3A4.04L	4"	101.6	2.11	184.2	92.1

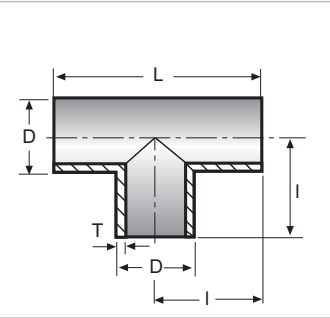

### E7WWWS - 3A - SHORT WELD TEE

Ordering Code	Size	Dimensions			
		D	T	L	I
E7WWWS3A1.04L	1"	25.4	1.65	57.2	41.3
E7WWWS3A1½4L	1½"	38.1	1.65	84.1	61.1
E7WWWS3A2.04L	2"	50.8	1.65	104.8	77.8
E7WWWS3A2½4L	2½"	63.5	1.65	117.5	90.5
E7WWWS3A3.04L	3"	76.2	1.65	131.8	104.0
E7WWWS3A4.04L	4"	101.6	2.11	184.2	142.9

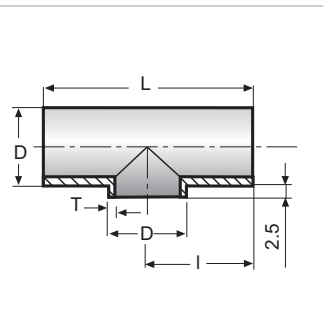



### E7RWWW - 3A - REDUCING TEE

Ordering Code	Size	Dimensions					
		L	L/2	H	D	E	T
E7RWWW3A1½1.04L	1½ x 1	114.4	57.2	73.1	38.1	25.4	1.65
E7RWWW3A2.01.04L	2 x 1	152.4	76.2	85.7	50.8	25.4	1.65
E7RWWW3A2.01½4L	2 x 1½	152.4	76.2	88.9	50.8	38.1	1.65
E7RWWW3A2½1.04L	2½ x 1	152.4	76.2	98.3	63.5	25.4	1.65
E7RWWW3A2½1½4L	2½ x 1½	152.4	76.2	101.7	63.5	38.1	1.65
E7RWWW3A2½2.04L	2½ x 2	152.4	76.2	114.3	63.5	50.8	1.65
E7RWWW3A3.01.04L	3 x 1	164.6	82.3	110.0	76.2	25.4	1.65
E7RWWW3A3.01½4L	3 x 1½	164.6	82.3	114.3	76.2	38.1	1.65
E7RWWW3A3.02.04L	3 x 2	164.6	82.3	127	76.2	50.8	1.65
E7RWWW3A3.02½4L	3 x 2½	164.6	82.3	120.4	76.2	63.5	1.65
E7RWWW3A4.02.04L	4 x 2	196.8	98.4	152.4	101.6	50.8	2.11
E7RWWW3A4.02½4L	4 x 2½	196.8	98.4	146.1	101.6	63.5	2.11
E7RWWW3A4.03.04L	4 x 3	196.8	98.4	146.1	101.6	76.2	2.11

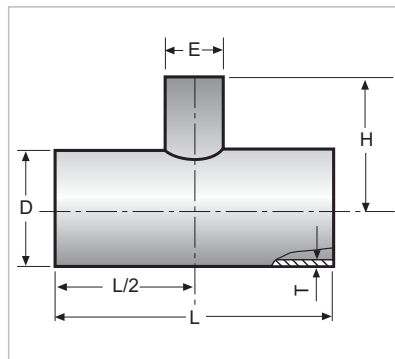



### E31WW - 3A - CONCENTRIC REDUCER

Ordering Code	Size	Dimensions		
		A	D	d
E31WW3A1.01½4L	1" X 1½"	50.8	38.1	25.4
E31WW3A1.02.04L	1" X 2"	101.6	50.8	25.4
E31WW3A1½2.04L	1½" X 2"	50.8	50.8	38.1
E31WW3A1½2½4L	1½" X 2½"	101.6	63.5	38.1
E31WW3A1½3.04L	1½" X 3"	152.4	76.2	38.1
E31WW3A2.02½4L	2" X 2½"	50.8	63.5	50.8
E31WW3A2.03.04L	2" X 3"	101.6	76.2	50.8
E31WW3A2.04.04L	2" X 4"	203.2	101.6	50.8
E31WW3A2½3.04L	2½" X 3"	50.8	76.2	63.5
E31WW3A2½4.04L	2½" X 4"	152.4	101.6	63.5
E31WW3A3.04.04L	3" X 4"	101.6	101.6	76.2

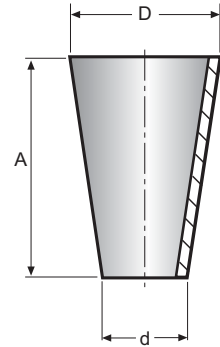

### E32WW - 3A - ECCENTRIC REDUCER

Ordering Code	Size	Dimensions		
		A	D	d
E32WW3A1.01.54L	1" X 1.5"	50.8	38.1	25.4
E32WW3A1.02.04L	1" X 2"	50.8	50.8	25.4
E32WW3A1.52.04L	1.5 X 2"	50.8	50.8	38.1
E32WW3A1.52.54L	1.5 X 2.5"	101.6	63.5	38.1
E32WW3A1.53.04L	1.5 X 3"	50.8	76.2	63.5
E32WW3A2.02.54L	2" X 2.5"	101.6	63.5	50.8
E32WW3A2.03.04L	2" X 3"	101.6	76.2	50.8
E32WW3A2.04.04L	2" X 4"	101.6	101.6	50.8
E32WW3A2.53.04L	2.5" X 3"	50.8	76.2	63.5
E32WW3A2.54.04L	2.5" X 4"	50.8	101.6	63.5
E32WW3A3.04.04L	3" X 4"	101.6	101.6	76.2

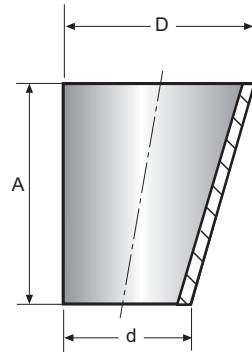



### EG2C - 3A - 90° CLAMP ELBOW

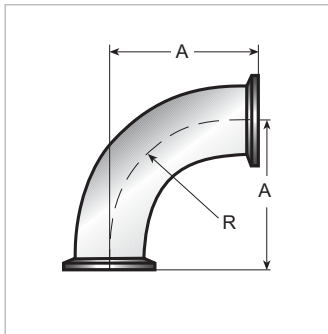

Ordering Code	Size	Dimensions	
		A	R
EG2C3A1.04L	1"	50.8	38.10
EG2C3A1½4L	1½"	69.85	57.15
EG2C3A2.04L	2"	88.90	76.20
EG2C3A2½4L	2½"	107.95	95.25
EG2C3A3.04L	3"	127.0	114.3
EG2C3A4.04L	4"	168.30	152.40

### EG2K - 3A - 45° CLAMP ELBOW

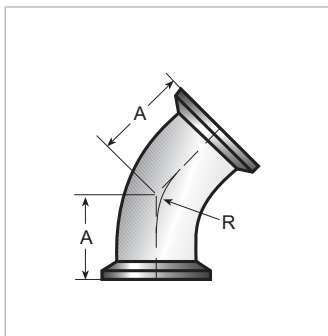

Ordering Code	Size	Dimensions	
		A	R
EG2K3A1.04L	1"	28.57	38.10
EG2K3A1½4L	1½"	36.51	57.15
EG2K3A2.04L	2"	44.45	76.20
EG2K3A2½4L	2½"	52.38	95.25
EG2K3A3.04L	3"	60.33	114.3
EG2K3A4.04L	4"	79.38	152.40

### EG7 - 3A - CLAMP TEE

Ordering Code	Size	Dimensions	
		A	B
EG73A1.04L	1"	60.30	120.60
EG73A1½4L	1½"	69.85	139.70
EG73A2.04L	2"	88.90	177.80
EG73A2½4L	2½"	88.90	177.80
EG73A3.04L	3"	95.25	190.50
EG73A4.04L	4"	114.30	228.60

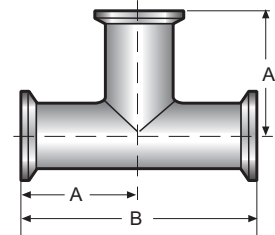

### EG9 - 3A - CLAMP CROSS

Ordering Code	Size	Dimensions	
		A	B
EG93A1.04L	1"	60.30	120.60
EG93A1½4L	1½"	69.85	139.70
EG93A2.04L	2"	88.90	177.80
EG93A2½4L	2½"	88.90	177.80
EG93A3.04L	3"	95.25	190.50
EG93A4.04L	4"	114.30	228.60

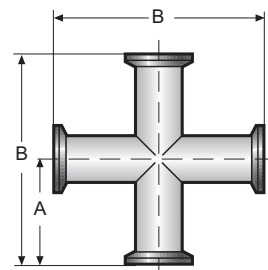

### E9WWWW - 3A - CROSS

Ordering Code	Size	Dimensions			
		A	B	D	T
E9WWWW3A1.04L	1"	2 1/4	28.83	1"	1.65
E9WWWW3A1½4L	1½"	3 5/16	26.06	1.5"	1.65
E9WWWW3A2.04L	2"	4 1/8	50.86	2"	1.65
E9WWWW3A2½4L	2½"	4 11/16	51.14	2.5"	1.65
E9WWWW3A3.04L	3"	5 3/16	51.39	3"	1.65
E9WWWW3A4.04L	4"	6 7/8	76.64	4"	2.11

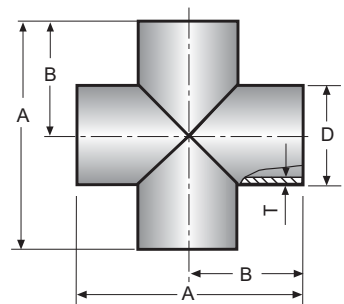



### EG31CC - 3A - CLAMP CONCENTRIC REDUCER

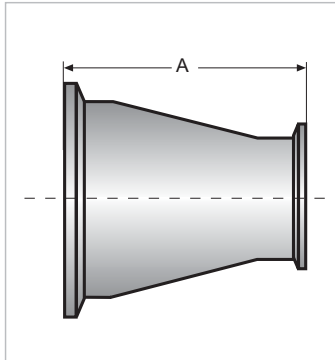

Ordering Code	Size	Dimensions
A		
EG31CC3A $\frac{3}{4}$ x $\frac{1}{2}$ 4L	$\frac{3}{4}$ x $\frac{1}{2}$	50.8
EG31CC3A1.0 x $\frac{1}{2}$ 4L	1 x $\frac{1}{2}$	50.8
EG31CC3A1.0 x $\frac{3}{4}$ 4L	1 x $\frac{3}{4}$	50.8
EG31CC3A1 $\frac{1}{2}$ x $\frac{1}{2}$ 4L	$1\frac{1}{2}$ x $\frac{1}{2}$	76.2
EG31CC3A1 $\frac{1}{2}$ x $\frac{3}{4}$ 4L	$1\frac{1}{2}$ x $\frac{3}{4}$	76.2
EG31CC3A1 $\frac{1}{2}$ x 1.04L	$1\frac{1}{2}$ x 1	76.2
EG31CC3A1 $\frac{1}{2}$ x $1\frac{1}{4}$ 4L	$1\frac{1}{2}$ x $1\frac{1}{4}$	76.2
EG31CC3A2.0 x 1.04L	2 x 1	127.0
EG31CC3A2.0 x $1\frac{1}{4}$ 4L	2 x $1\frac{1}{4}$	50.8
EG31CC3A2.0 x $1\frac{1}{2}$ 4L	2 x $1\frac{1}{2}$	76.2
EG31CC3A2 $\frac{1}{2}$ x 1.04L	$2\frac{1}{2}$ x 1	177.8
EG31CC3A2 $\frac{1}{2}$ x $1\frac{1}{2}$ 4L	$2\frac{1}{2}$ x $1\frac{1}{2}$	127.0
EG31CC3A2 $\frac{1}{2}$ x 2.04L	$2\frac{1}{2}$ x 2	76.2
EG31CC3A3.0 x $1\frac{1}{2}$ 4L	3 x $1\frac{1}{2}$	177.8
EG31CC3A3.0 x 2.04L	3 x 2	127.0
EG31CC3A3.0 x $2\frac{1}{2}$ 4L	3 x $2\frac{1}{2}$	76.2
EG31CC3A4.0 x 2.04L	4 x 2	231.9
EG31CC3A4.0 x $2\frac{1}{2}$ 4L	4 x $2\frac{1}{2}$	181.1
EG31CC3A4.0 x 3.04L	4 x 3	130.3

### EG32CC - 3A - CLAMP ECCENTRIC REDUCER

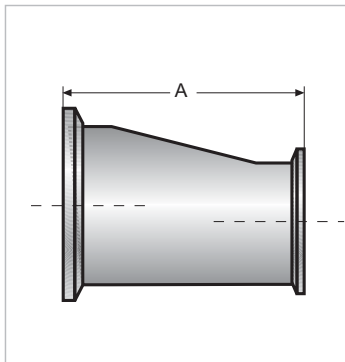

Ordering Code	Size	Dimensions
A		
EG32CC3A $\frac{3}{4}$ x $\frac{1}{2}$ 4L	$\frac{3}{4}$ x $\frac{1}{2}$	50.8
EG32CC3A1.0 x $\frac{1}{2}$ 4L	1 x $\frac{1}{2}$	76.2
EG32CC3A1.0 x $\frac{3}{4}$ 4L	1 x $\frac{3}{4}$	50.8
EG32CC3A1 $\frac{1}{2}$ x $\frac{1}{2}$ 4L	$1\frac{1}{2}$ x $\frac{1}{2}$	127.0
EG32CC3A1 $\frac{1}{2}$ x $\frac{3}{4}$ 4L	$1\frac{1}{2}$ x $\frac{3}{4}$	101.6
EG32CC3A1 $\frac{1}{2}$ x 1.04L	$1\frac{1}{2}$ x 1	76.2
EG32CC3A1 $\frac{1}{2}$ x $1\frac{1}{4}$ 4L	$1\frac{1}{2}$ x $1\frac{1}{4}$	50.8
EG32CC3A2.0 x 1.04L	2 x 1	127.0
EG32CC3A2.0 x $1\frac{1}{4}$ 4L	2 x $1\frac{1}{4}$	50.8
EG32CC3A2.0 x $1\frac{1}{2}$ 4L	2 x $1\frac{1}{2}$	76.2
EG32CC3A2 $\frac{1}{2}$ x 1.04L	$2\frac{1}{2}$ x 1	177.8
EG32CC3A2 $\frac{1}{2}$ x $1\frac{1}{2}$ 4L	$2\frac{1}{2}$ x $1\frac{1}{2}$	127.0
EG32CC3A2 $\frac{1}{2}$ x 2.04L	$2\frac{1}{2}$ x 2	76.2
EG32CC3A3.0 x $1\frac{1}{2}$ 4L	3 x $1\frac{1}{2}$	177.8
EG32CC3A3.0 x 2.04L	3 x 2	127.0
EG32CC3A3.0 x $2\frac{1}{2}$ 4L	3 x $2\frac{1}{2}$	76.2
EG32CC3A4.0 x 2.04L	4 x 2	231.9
EG32CC3A4.0 x $2\frac{1}{2}$ 4L	4 x $2\frac{1}{2}$	181.1
EG32CC3A4.0 x 3.04L	4 x 3	130.3



### EG2CS - SHORT WELDING FERRULE

Ordering Code	Size	Dimensions		
		A	B	D
EG2CS3A1.04L	1"	12.7	22.1	25.4
EG2CS3A1½4L	1½"	12.7	34.8	38.1
EG2CS3A2.04L	2"	12.7	47.5	50.8
EG2CS3A2½4L	2½"	12.7	60.2	63.5
EG2CS3A3.04L	3"	12.7	72.9	76.2
EG2CS3A4.04L	4"	15.9	97.38	101.6

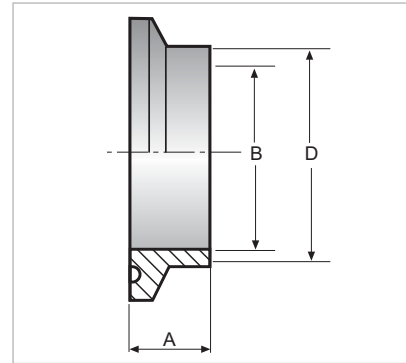

### EG14AM7 - LONG WELDING FERRULE

Ordering Code	Size	Dimensions			
		A	B	C	D
EG14AM73A1.04L	1"	50.5	28.6	22.1	25.4
EG14AM73A1½4L	1½"	50.5	28.6	34.8	38.1
EG14AM73A2.04L	2"	64	28.6	47.5	50.8
EG14AM73A2½4L	2½"	77.5	28.6	60.2	63.5
EG14AM73A3.04L	3"	91	28.6	72.9	76.2
EG14AM73A4.04L	4"	119	28.6	97.38	101.6

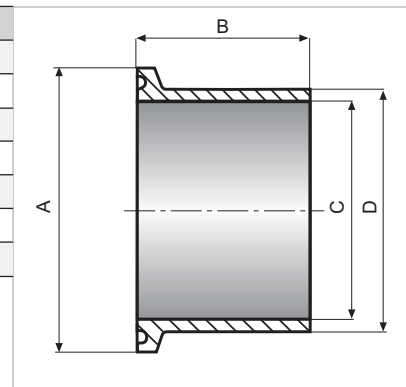

### EG16A - SOLID END CAP

Ordering Code	Size	Dimensions	
		A	B
EG16A3A1½4L	1"-1½"	50.5	6.35
EG16A3A2.04L	2"	64.0	6.35
EG16A3A2½4L	2½"	77.5	6.35
EG16A3A3.04L	3"	91.0	6.35
EG16A3A4.04L	4"	119	7.9

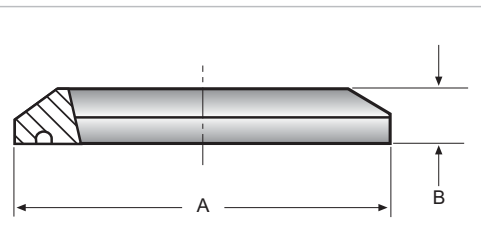

### EG-40- GASKET \*

Ordering Code	Size	Dimensions		
		A	B	C
EG403A1.0	1"	50.5	22.1	4.5
EG403A1½	1½"	50.5	34.8	4.5
EG403A2.0	2"	64	47.5	4.5
EG403A2½	2½"	77.5	60.2	4.5
EG403A3.0	3"	91	72.9	4.5
EG403A4.0	4"	119	97.38	4.5

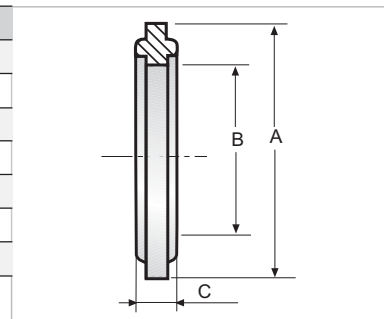

\* Available in EPDM, SILICON, VITON®, PTFE®

\* Please specify Gasket material.



### 13MHHMD-DOUBLE HINGED HEAVY DUTY CLAMP

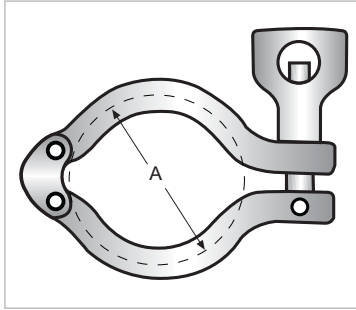

Ordering Code	Size	Dimensions
		A
EG13MHHMD3A1½	1" & 1½"	5.8
EG13MHHMD3A2.0	2"	67.4
EG13MHHMD3A2½	2½"	80.8
EG13MHHMD3A3.0	3"	94.4
EG13MHHMD3A4.0	4"	108.7

### 13MHHM-H-HEAVY DUTY CLAMP

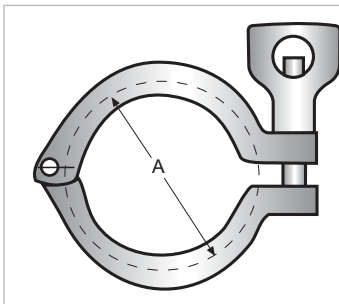

Ordering Code	Size	Dimensions
		A
EG13MHHM-H3A¾	½" & ¾"	28.9
EG13MHHM-H3A1½	1" & 1½"	53.8
EG13MHHM-H3A2.0	2"	67.4
EG13MHHM-H3A2½	2½"	80.8
EG13MHHM-H3A3.0	3"	94.4
EG13MHHM-H3A4.0	4"	122.4
EG13MHHM-H3A6.0	6"	170.05

### 13MHHS-THREE PIECE HEAVY DUTY CLAMP

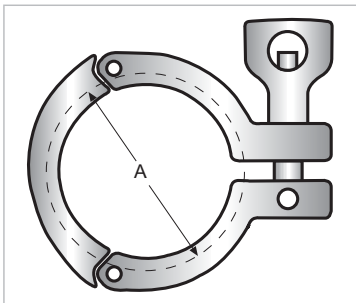

Ordering Code	Size	Dimensions
		A
EG13MHHS3A1½	1" & 1½"	53.8
EG13MHHS3A2.0	2"	67.4
EG13MHHS3A2½	2½"	80.8
EG13MHHS3A3.0	3"	94.4
EG13MHHS3A4.0	4"	108.7

### 13MHHM - HEAVY DUTY CLAMP

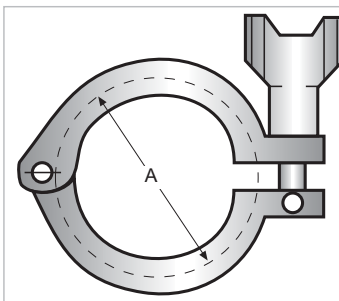

Ordering Code	Size	Dimensions
		A
EG13MHHM3A¾	½" & ¾"	28.5
EG13MHHM3A1½	1" & 1½"	53.8
EG13MHHM3A2.0	2"	64.5
EG13MHHM3A2½	2½"	80.8
EG13MHHM3A3.0	3"	94.4
EG13MHHM3A4.0	4"	122.42
EG13MHHM3A6.0	6"	170.05





# DIN

DIN, the German Institute for Standardization, is a registered association, founded in 1917. Its head office is in Berlin. Since 1975 it has been recognized by the German government as the national standards body and represents German interests at international and European level. DIN 11851 - Fittings for food, chemical and pharmaceutical industry; Stainless steel screwed pipe connections; Design for rolling in and welding-on. DIN 11852 - Valves for food and chemical industries; Stainless steel fittings; Tees, bends, reducers for welding-on. DIN 11851 / 2 standards are used on the majority of the German hygienic equipment and are gaining widespread acceptance.

### **Weld fittings:**

Weld fittings are offered for DIN 11851 and DIN 11852 standards, in nominal tube sizes DN 25-100, in AISI 304L (1.4306) and AISI 316L (1.4404) materials. Uniform wall thickness measures: DIN 11850 DN 25-50 1.5 mm, DN 65-100 2.0 mm.

### **Unions:**

EGMO offers DIN 11851 unions in AISI 304L (1.4306) and AISI 316L (1.4404) materials in nominal tube sizes DN 25-100. Uniform wall thickness measures: DN 25-50 1.5 mm, DN 65-100 2.0 mm. Gaskets unions are available in several different materials: Buna-N, EPDM, SILICON®, PTFE® and Viton®

### **Tubing:**

DN 25-100 tubing is offered in AISI 304L (1.4306) and AISI 316L (1.4404) stainless steel. A variety of surface finish combinations are available: mill finished mechanically polished and electro-polished.

### **Customized components:**

EGMO manufactures products to your specific needs with one of the shortest lead times in the industry.





### 2WCL - DIN - 90° ELBOW SHORT TANGENT

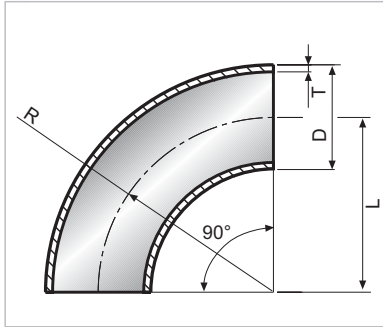

Ordering Code	Size	Dimensions			
		D	T	R	L
2WCLDIN254L	DN 25	28	1.5	50	50
2WCLDIN324L	DN 32	34	1.5	55	55
2WCLDIN404L	DN 40	40	1.5	60	60
2WCLDIN504L	DN 50	52	1.5	70	70
2WCLDIN654L	DN 65	70	2.0	80	80
2WCLDIN804L	DN 80	85	2.0	90	90
2WCLDIN1004L	DN 100	104	2.0	100	100

### E2S - DIN 11851 - 90° ELBOW LONG TANGENT

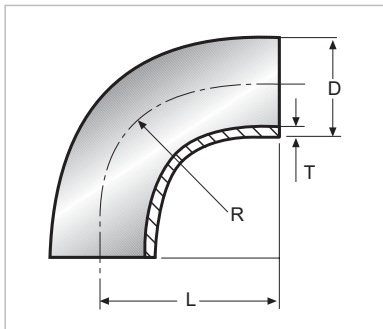

Ordering Code	Size	Dimensions			
		D	T	R	L
E2SDIN254L	DN 25	28	1.5	50	65
E2SDIN324L	DN 32	34	1.5	55	73
E2SDIN404L	DN 40	40	1.5	60	80
E2SDIN504L	DN 50	52	1.5	70	92
E2SDIN654L	DN 65	70	2	80	120
E2SDIN804L	DN 80	85	2	90	119
E2SDIN1004L	DN 100	104	2	100	143

### E2S2 - DIN 11852 - 90° ELBOW LONG TANGENT

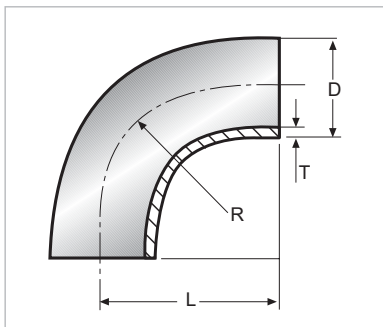

Ordering Code	Size	Dimensions			
		D	T	R	L
E2S2DIN2254L	DN 25	29	1.5	50	90
E2S2DIN2324L	DN 32	35	1.5	55	95
E2S2DIN2404L	DN 40	41	1.5	60	100
E2S2DIN2504L	DN 50	53	1.5	70	110
E2S2DIN2654L	DN 65	70	2	80	120
E2S2DIN2804L	DN 80	85	2	90	145
E2S2DIN21004L	DN 100	104	2	100	155

### E2WK - DIN - 45° ELBOW SHORT TANGENT

Ordering Code	Size	Dimensions			
		D	T	R	L
E2WKDIN254L	DN 25	28	1.5	50	44.4
E2WKDIN324L	DN 32	34	1.5	55	50.0
E2WKDIN404L	DN 40	40	1.5	60	55.7
E2WKDIN504L	DN 50	52	1.5	70	67.0
E2WKDIN654L	DN 65	70	2.0	80	80.4
E2WKDIN804L	DN 80	85	2.0	90	92.8
E2WKDIN1004L	DN 100	104	2.0	100	106.6

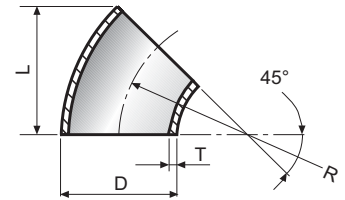

### E7WWW - DIN - TEE

Ordering Code	Size	Dimensions			
		D	T	L	I
E7WWWSDIN254L	DN 25	28	1.5	100	50
E7WWWSDIN324L	DN 32	34	1.5	110	55
E7WWWSDIN404L	DN 40	40	1.5	120	60
E7WWWSDIN504L	DN 50	52	1.5	140	70
E7WWWSDIN654L	DN 65	70	2.0	160	80
E7WWWSDIN804L	DN 80	85	2.0	180	90
E7WWWSDIN1004L	DN 100	104	2.0	200	100

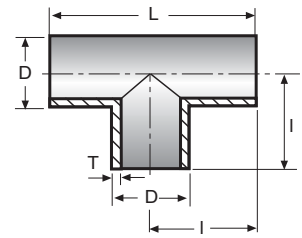

### E7WWW S - DIN - SHORT WELD TEE

Ordering Code	Size	Dimensions			
		D	T	L	I
E7WWWSDIN254L	DN 25	28	1.5	100	50
E7WWWSDIN324L	DN 32	34	1.5	110	55
E7WWWSDIN404L	DN 40	40	1.5	120	60
E7WWWSDIN504L	DN 50	52	1.5	140	70
E7WWWSDIN654L	DN 65	70	2.0	160	80
E7WWWSDIN804L	DN 80	85	2.0	180	90
E7WWWSDIN1004L	DN 100	104	2.0	200	100

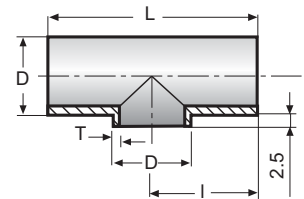



### E7RWWW - DIN - REDUCING TEE

Ordering Code	Size	Dimensions					
		D	d	L	I	T	t
E7RWWWWDIN50254L	NW50X25	52	28	140	40	1.5	1.5
E7RWWWWDIN50404L	NW50X40	52	40	140	40	1.5	1.5
E7RWWWWDIN65504L	NW65X50	65	52	160	70	2.0	1.5
E7RWWWWDIN80504L	NW80X50	85	52	180	70	2.0	1.5
E7RWWWWDIN80654L	NW80X65	85	70	180	80	2.0	2.0
E7RWWWWDIN100654L	NW100X65	104	70	200	80	2.0	2.0

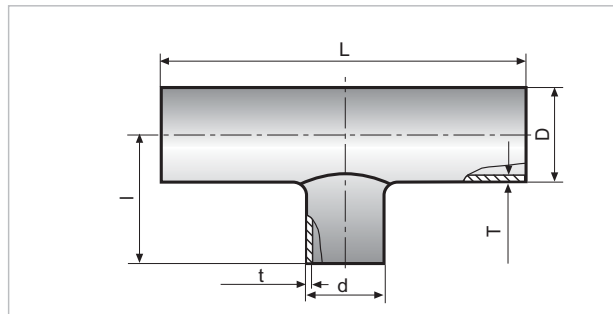

### E7WWWCS - DIN - SHORT CLAMP BRANCH TEE

Ordering Code	Size	Dimensions			
		D	L	I	T
E7WWWCS DIN404L	NW40x1½"	40	124	35	1.5
E7WWWCS DIN504L	NW50x1½"	52	140	41	1.5
E7WWWCS DIN654L	NW65x1½"	70	160	50	2.0
E7WWWCS DIN804L	NW80x1½"	85	180	58	2.0

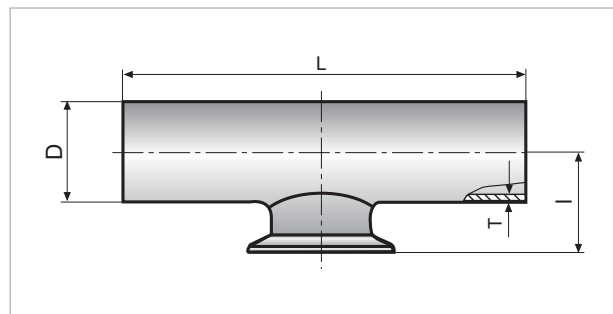



### E31WW - DIN - CONCENTRIC REDUCER

Ordering Code	Size	Dimensions		
		A	D	d
E31WWDIN25324L	25 X 32	50	34	28
E31WWDIN25404L	25 X 40	50	40	40
E31WWDIN25504L	25 X 50	100	52	28
E31WWDIN25654L	25 X 65	150	70	28
E31WWDIN32404L	32 X 40	50	40	34
E31WWDIN32504L	32 X 50	50	52	34
E31WWDIN40504L	40 X 50	50	52	40
E31WWDIN40654L	40 X 65	100	70	40
E31WWDIN50654L	50 X 65	50	70	52
E31WWDIN50804L	50 X 80	135	85	52
E31WWDIN65804L	65 X 80	60	85	70
E31WWDIN651004L	65 X 100	150	104	70
E31WWDIN801004L	80 X 100	50	104	85

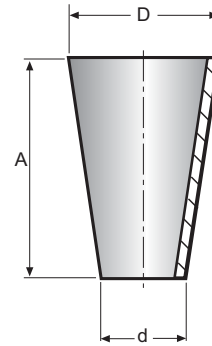

### E32WW - DIN - ECCENTRIC REDUCER

Ordering Code	Size	Dimensions		
		A	D	d
E32WWDIN25324L	25 X 32	24	28	34
E32WWDIN25404L	25 X 40	48	28	40
E32WWDIN25504L	25 X 50	96	28	52
E32WWDIN25654L	25 X 65	167	28	70
E32WWDIN32404L	32 X 40	24	34	40
E32WWDIN32504L	32 X 50	72	34	52
E32WWDIN40504L	40 X 50	48	40	52
E32WWDIN40654L	40 X 65	119	40	70
E32WWDIN50654L	50 X 65	71	52	70
E32WWDIN50804L	50 X 80	132	52	85
E32WWDIN65804L	65 X 80	60	70	85
E32WWDIN651004L	65 X 100	136	70	104
E32WWDIN801004L	80 X 100	76	85	104

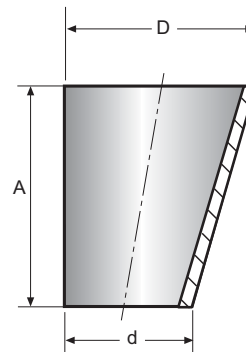



### DIN UNION

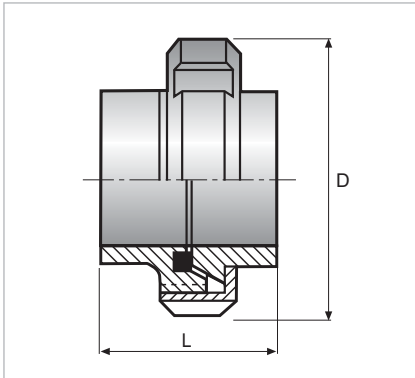

Ordering Code	Size	Dimensions	
		D	L
6DIN104L	DN 10	38	27
6DIN254L	DN 25	63	32
6DIN324L	DN 32	70	32
6DIN404L	DN 40	78	32
6DIN504L	DN 50	92	34
6DIN654L	DN 65	112	35
6DIN804L	DN 80	127	35
6DIN1004L	DN 100	148	42

\* Please specify Gasket material.

### DIN MALE

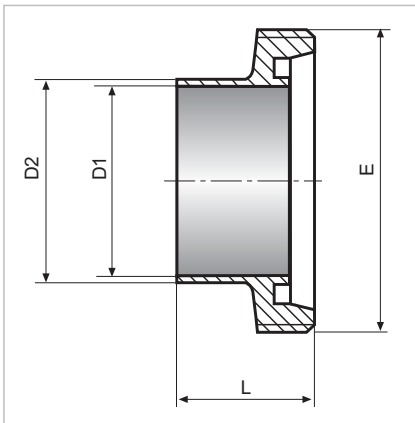

Ordering Code	Size	Dimensions			
		D1	D2	E	L
2LDIN254L	DN 25	26	30	Rd 52x1/6"	22
2LDIN324L	DN 32	32	36	Rd 58x1/6"	22
2LDIN404L	DN 40	38	42	Rd 65x1/6"	22
2LDIN504L	DN 50	50	54	Rd 78x1/6"	23
2LDIN654L	DN 65	66	71	Rd 95x1/6"	25
2LDIN804L	DN 80	81	86	Rd 110x1/4"	25
2LDIN1004L	DN 100	100	105	Rd 130x1/4"	30

### DIN LINER

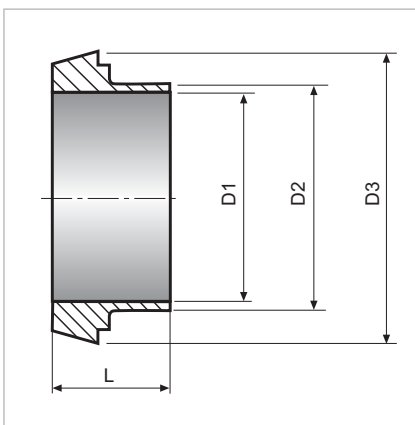

Ordering Code	Size	Dimensions			
		D1	D2	D3	L
3LDIN254L	DN 25	26	29	44	15
3LDIN324L	DN 32	32	35	50	15
3LDIN404L	DN 40	38	41	56	15
3LDIN504L	DN 50	50	53	68.5	16
3LDIN654L	DN 65	66	70	86	17
3LDIN804L	DN 80	81	85	100	17
3LDIN1004L	DN 100	100	104	121	20



### DIN NUT

Ordering Code	Size	Dimensions				
		D	D1	E	L	L1
4DIN254L	DN 25	63	36	Rd 52x1/6"	21	18
4DIN324L	DN 32	70	42	Rd 58x1/6"	21	18
4DIN404L	DN 40	78	49	Rd 65x1/6"	21	18
4DIN504L	DN 50	92	62	Rd 78x1/6"	22	19
4DIN654L	DN 65	112	80	Rd 95x1/6"	25	21
4DIN804L	DN 80	127	94	Rd 110x1/4"	29	25
4DIN1004L	DN 100	148	115	Rd 130x1/4"	31	26

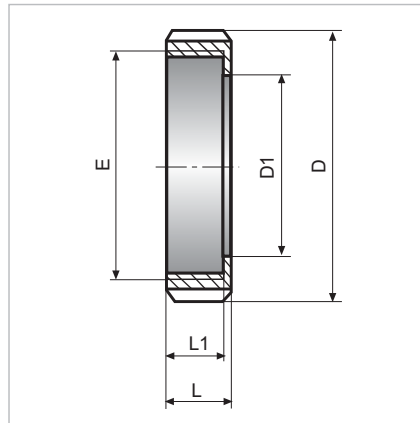

### DIN GASKET \*

Ordering Code	Size	Dimensions		
		D1	D2	S
5DIN25	DN 25	30	40	5
5DIN32	DN 32	36	46	5
5DIN40	DN 40	42	52	5
5DIN50	DN 50	54	64	5
5DIN65	DN 65	71	81	5
5DIN80	DN 80	85	95	5
5DIN100	DN 100	104	114	6

\* Available in EPDM, SILICON, VITON®, PTFE®

\* Please specify Gasket material.

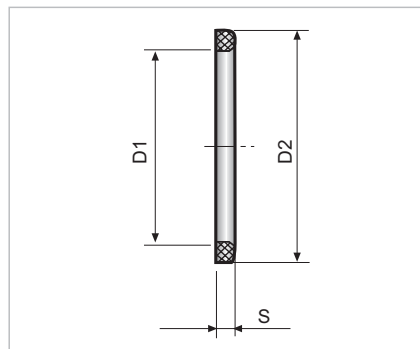



# BS

BS 4825 - Stainless steel tubes and fittings for the food industry and other hygienic applications. BS is widely used throughout the UK hygienic industries. It can be used on permanently installed pipelines but it is also designed for use where systems are frequently dismantled. RJT - conforming to BS 4825 part 5 and should be used in applications where manual cleaning is employed. Particularly suited where lines are frequently dismantled due to their robust construction and ease of alignment.

### **Weld fittings:**

Weld fittings are offered for BS standard in nominal tube sizes ½" through 4", in AISI 304L (1.4306) and AISI 316L (1.4404) materials. Uniform wall thickness measures: ASTM A-269/270 1"-3" 0.065" (1.65 mm), 4" 0.083" (2.11 mm).

### **Tubing:**

Tubing is offered ½" through 4" in AISI 304L (1.4306) and AISI 316L (1.4404) stainless steel. A variety of surface finish combinations are available: mill finished, mechanically polished and electropolished according to ASTM A-269/270 standards.

### **Unions**

EGMO offers BS 4825 unions in AISI 304L (1.4306) and AISI 316L (1.4404) materials in nominal tube sizes 1" through 4". Uniform wall thickness measures: ASTM A-269/270 1-3" 0.065" (1.65 mm), 4" 0.083" (2.11 mm). Gaskets unions are available in several different materials: Buna-N, EPDM, SILICON®, PTFE® and Viton®.

### **Customized components:**

EGMO manufactures products to your specific needs with one of the shortest lead times in the industry.





### 2WCL - BS - 90° ELBOW SHORT TANGENT

Ordering Code	Size	Dimensions			
		D	T	R	I
2WCLBS1.04L	1"	25.4	1.65	38.1	44
2WCLBS1½4L	1½"	38.1	1.65	57.2	64
2WCLBS2.04L	2"	50.8	1.65	76.2	89
2WCLBS2½4L	2½"	63.5	1.65	95.3	114
2WCLBS3.04L	3"	76.2	1.65	114.3	134
2WCLBS4.04L	4"	101.6	2.1	152.4	174

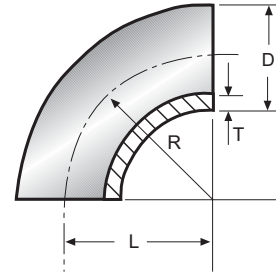

### E2S - BS - 90° ELBOW LONG TANGENT

Ordering Code	Size	Dimensions			
		D	T	R	L
E2SBS1.04L	1"	25.4	1.65	38.1	65
E2SBS1½4L	1½"	38.1	1.65	57.2	85
E2SBS2.04L	2"	50.8	1.65	76.2	110
E2SBS2½4L	2½"	63.5	1.65	95.3	135
E2SBS3.04L	3"	76.2	1.65	114.3	155
E2SBS4.04L	4"	101.6	2.11	152.4	195

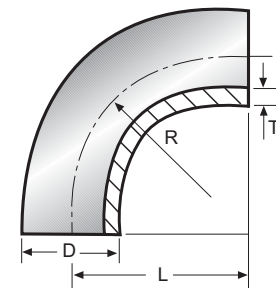

### E2WK - BS - 45° ELBOW SHORT TANGENT

Ordering Code	Size	Dimensions			
		D	T	R	A
E2WKBS1.04L	1"	25.4	1.65	38.1	15.9
E2WKBS1½4L	1½"	38.1	1.65	57.2	23.8
E2WKBS2.04L	2"	50.8	1.65	76.2	31.8
E2WKBS2½4L	2½"	63.5	1.65	95.3	39.7
E2WKBS3.04L	3"	76.2	1.65	114.3	47.6
E2WKBS4.04L	4"	101.6	2.1	152.4	63.5

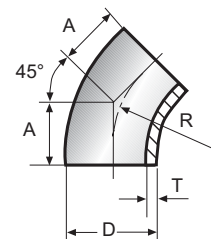

### E2KS - BS - 45° ELBOW LONG TANGENT

Ordering Code	Size	Dimensions		
		D	A	T
E2KSBS1.04L	1"	25.4	30.15	1.65
E2KSBS1½4L	1½"	38.1	41.30	1.65
E2KSBS2.04L	2"	50.8	58.70	1.65
E2KSBS2½4L	2½"	63.5	76.20	1.65
E2KSBS3.04L	3"	76.2	93.70	1.65
E2KSBS4.04L	4"	101.6	122.20	2.11

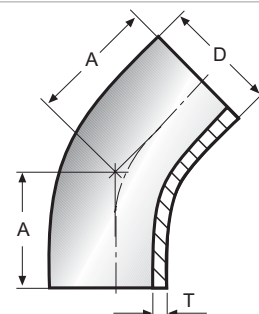



### BS (RJT) UNION

Ordering Code	Size	Dimensions	
		D	L
6RJT1.04L	1"	57	36
6RJT1½4L	1½"	72	36
6RJT2.04L	2"	86	36
6RJT2½4L	2½"	100	36
6RJT3.04L	3"	114	36
6RJT4.04L	4"	141	36

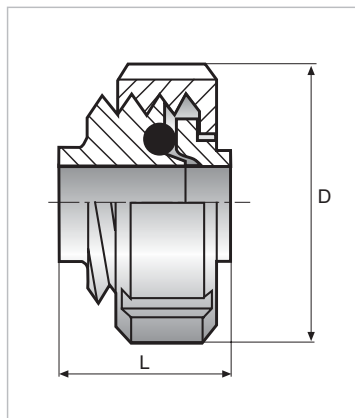

### BS (RJT) MALE

Ordering Code	Size	Dimensions		
		A	D	B (Ref.)
2BS1.04L	1"	26.5	22.5	45.7
2BS1½4L	1½"	39.9	34.9	58.4
2BS2.04L	2"	52.6	47.6	72.7
2BS2½4L	2½"	64.5	59.5	85.4
2BS3.04L	3"	77.2	72.2	98.1
2BS4.04L	4"	102.6	97.6	123.5

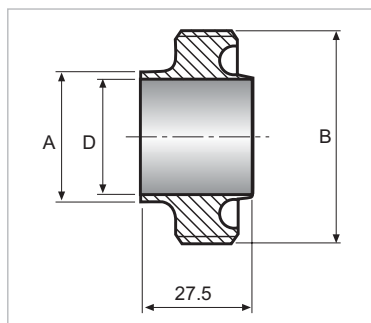

## BS (RJT) LINER

Ordering Code	Size	Dimensions			
		A	B	D	F
3BS1.04L	1"	41.3	27.9	32.5	22.1
3BS1½4L	1½"	54	40.7	45.2	34.8
3BS2.04L	2"	66.7	53.4	57.9	47.5
3BS2½4L	2½"	79.4	66.1	70.6	60.2
3BS3.04L	3"	92.1	78.8	83.3	72.9
3BS4.04L	4"	117.5	104.4	108.8	97.4

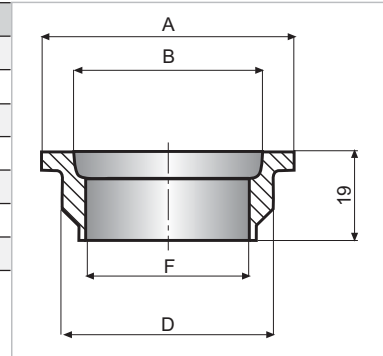

## BS (RJT) NUT

Ordering Code	Size	Dimensions		
		A	B	C
4BS1.04L	1"	57	Acc. to B.S 1864	33.3
4BS1½4L	1½"	72	Acc. to B.S 1864	46
4BS2.04L	2"	86	Acc. to B.S 1864	58.7
4BS2½4L	2½"	100	Acc. to B.S 1864	71.5
4BS3.04L	3"	114	Acc. to B.S 1864	84.1
4BS4.04L	4"	141	Acc. to B.S 1864	109.6

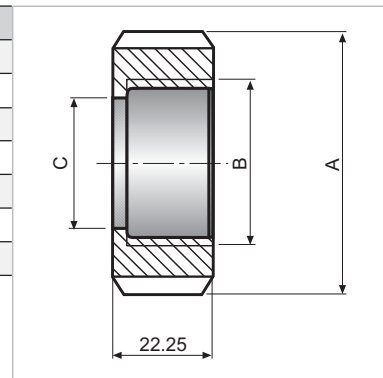

## BS (RJT) GASKET\*

Ordering Code	Size	Dimensions	
		D	d
5BS1.0	1"	40	26.8
5BS1½	1½"	52.6	39.4
5BS2.0	2"	65.3	52.1
5BS2½	2½"	78.1	64.9
5BS3.0	3"	90.6	77.4
5BS4.0	4"	116	102.8

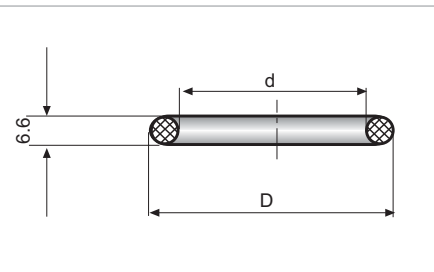

\* Available in EPDM, SILICON, VITON®, PTFE®.

\* Please specify Gasket material



Neumo Ehrenberg Group

Sanitary Stainless Steel

# SMS

SMS-Swedish Milk Standard for Stainless steel tubes and fittings for the food industry and other hygienic applications.

**Unions:**

EGMO offers SMS unions in AISI 304L (1.4306) and AISI 316L (1.4404) materials in nominal tube sizes 1" through 4". Uniform wall thickness measures: ASTM A-269/270 1-3" 0.065" (1.65 mm), 4" 0.083" (2.11 mm). Gaskets unions are available in several different materials: Buna-N, EPDM, SILICON®, PTFE®, and Viton®.

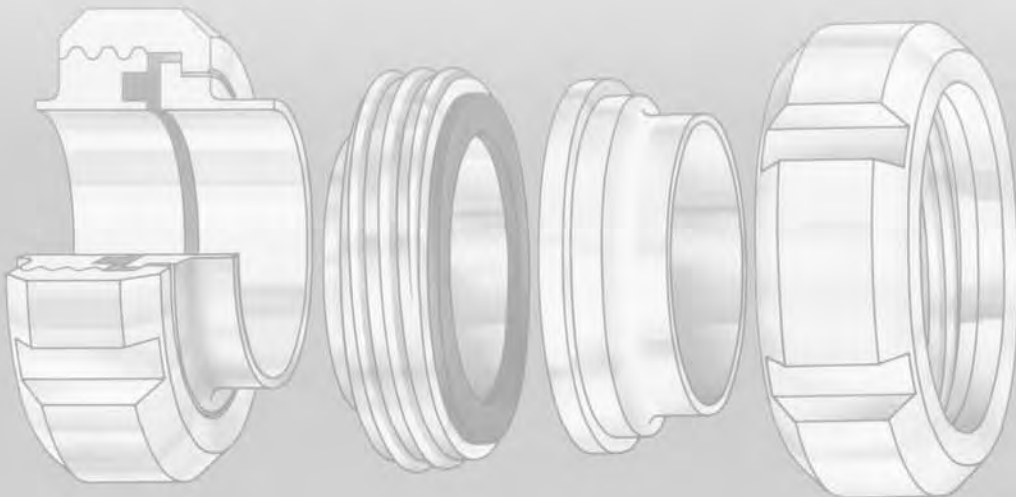

## SMS UNION

Ordering Code	Size	Dimensions	
		D	L
6SMS1.04L	1"	51	24
6SMS1½4L	1½"	74	31
6SMS2.04L	2"	84	31
6SMS2½4L	2½"	100	35
6SMS3.04L	3"	114	36
6SMS4.04L	4"	154	49

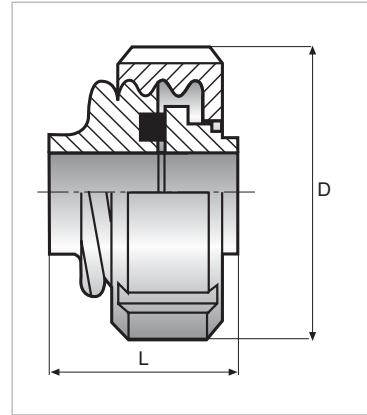

## SMS MALE

Ordering Code	Size	Dimensions			
		L	d1	d7	Rd. d5
2SMS1.04L	1"	15	22.1	25.9	40 X1/6"
2SMS1½4L	1½"	20	34.8	38.6	60 X1/6"
2SMS2.04L	2"	20	47.5	51.3	70 X1/6"
2SMS2½4L	2½"	24	60.2	64	85 X1/6"
2SMS3.04L	3"	24	72.2	76.7	98 X1/6"
2SMS4.04L	4"	35	97.4	102.6	132 X1/6"

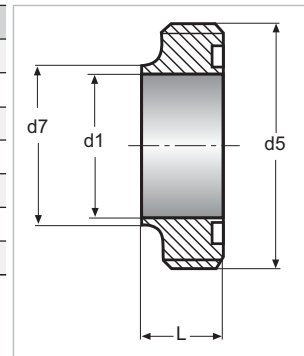

## SMS LINER

Ordering Code	Size	Dimensions			
		H	d1	d7	d6
3SMS1.04L	1"	7.5	22.1	25.9	35.5
3SMS1½4L	1½"	9	34.8	38.6	55
3SMS2.04L	2"	9	47.5	51.3	65
3SMS2½4L	2½"	9	60.2	64	80
3SMS3.04L	3"	10	72.2	76.7	93
3SMS4.04L	4"	12	97.4	102.6	127

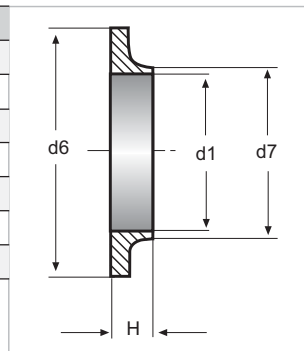



### SMS NUT

Ordering Code	Size	Dimensions		
		K	d10	Rd. d5
4SMS1.04L	1"	20	51	40 X1/6"
4SMS1½4L	1½"	25	74	60 X1/6"
4SMS2.04L	2"	26	84	70 X1/6"
4SMS2½4L	2½"	30	100	85 X1/6"
4SMS3.04L	3"	32	114	98 X1/6"
4SMS4.04L	4"	45	154	132 X1/6"

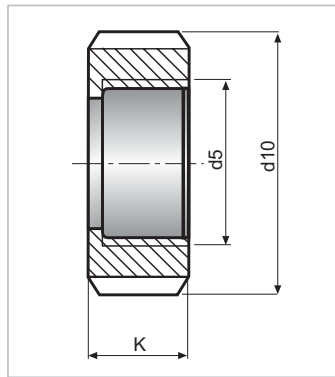

### SMS GASKET \*

Ordering Code	Size	Dimensions		
		S	d3	d11
5SMS1.0	1"	5.5	25	32
5SMS1½	1½"	5.5	38	48
5SMS2.0	2"	5.5	51	61
5SMS2½	2½"	5.5	63.5	73.5
5SMS3.0	3"	5.5	76	86
5SMS4.0	4"	5.5	101.6	114

\* Available in EPDM, SILICON, VITON®, PTFE®.

\* Please specify Gasket material

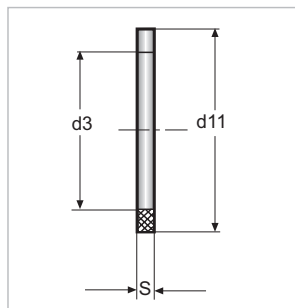



Neumo Ehrenberg Group

Sanitary Stainless Steel

# Valves & Actuators

**EGMO** designs, engineers, and manufactures a complete line of sanitary stainless steel valves and actuators including:

- \* Actuators - Pneumatic and air operated
- \* Single seat valves - Pneumatic and air operated
- \* Butterfly valves
- \* Sampling valves
- \* Check valves
- \* Manual Control

**The valve line comprises the following standards:**

- \* 3A
- \* DIN
- \* SMS
- \* BS/RJT





### \* EGWW - BUTTERFLY VALVE

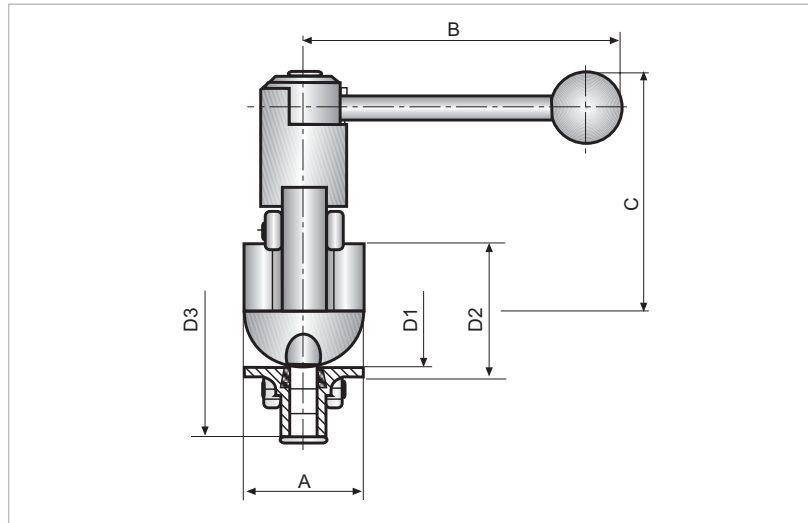

### EGWW - 3A - BUTTERFLY VALVE

Ordering Code	Size	Dimensions					
		A	B	C	D1	D2	D3
B1"WW4	1"	38	107	90	22.9	28	87
B1½"WW4	1½"	48	137	94	35.1	41	97
B2"WW4	2"	48	137	101	47.8	54	110
B2½"WW4	2½"	47	137	110	60.5	68	127
B3"WW4	3"	60	167	123	72.1	78	142
B4"WW4	4"	62	167	134	97.6	104	162

### EGWW - DIN - BUTTERFLY VALVE

Ordering Code	Size	Dimensions					
		A	B	C	D1	D2	D3
B25WW4	DN 25	40	107	90	26	31	87
B32WW4	DN 32	42	107	32	32	37	92
B40WW4	DN 40	50	137	34	38	43	97
B50WW4	DN 50	50	137	101	50	55	110
B65WW4	DN 65	50	137	110	66	72	127
B80WW4	DN 80	60	167	123	81	87	142
B100WW4	DN 100	64	167	134	100	106	162

\* Available in EPDM, SILICON, VITON® Gaskets.

\* Please specify Gasket material.

\* Detailed product brochure is available.



**BUTTERFLY VALVE - GASKET**

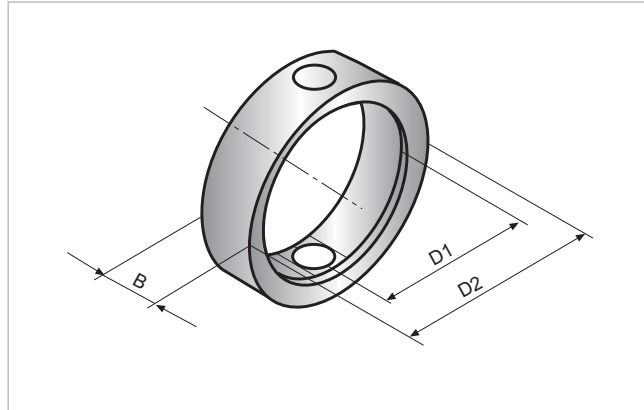

**BUTTERFLY VALVE - INCH GASKET**

Ordering Code	Size	Dimensions		
		D1	D2	B
BVS1.0	1"	26	40	20
BVS1½	1½"	38	54	21
BVS2.0	2"	51	67	21
BVS2½	2½"	60.5	80	22
BVS3.0	3"	74	93	24
BVS4.0	4"	101	116	26

**BUTTERFLY VALVE - DIN GASKET**

Ordering Code	Size	Dimensions		
		D1	D2	B
BVS25	DN 25	26	40	20
BVS32	DN 32	32	48	20
BVS40	DN 40	38	54	21
BVS50	DN 50	51	67	21
BVS65	DN 65	67	85	22
BVS80	DN 80	82	101	24
BVS100	DN 100	101	116	26

\* Available in EPDM, SILICON, VITON®.

\* Please specify Gasket material.



## \* MINI - BUTTERFLY AND BALL VALVE ACTUATOR

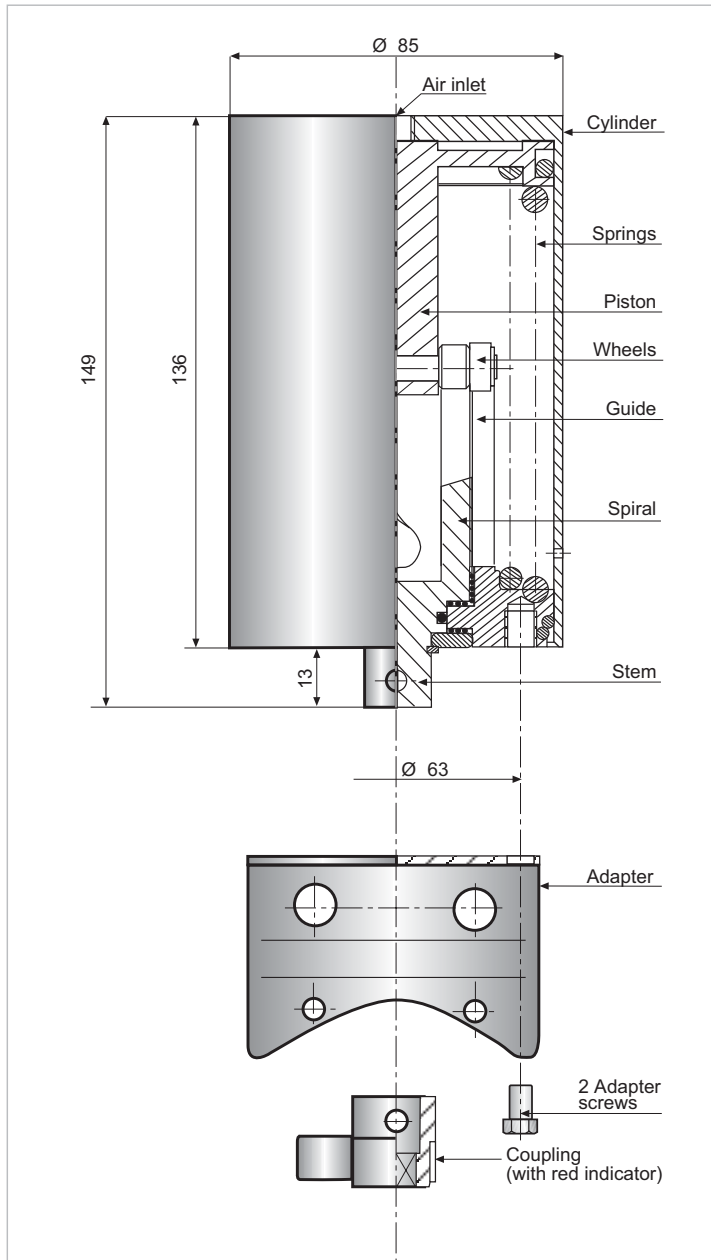

### MINI BUTTERFLY VALVE ACTUATOR

Ordering Code	Size
EBA1W1A	1"-4"/DN 25-100

### MINI BALL VALVE ACTUATOR

Ordering Code	Size
EBA1W2A	1/2"-2"

\* Detailed product brochure is available.



\* MIDI - BUTTERFLY AND BALL VALVE ACTUATOR

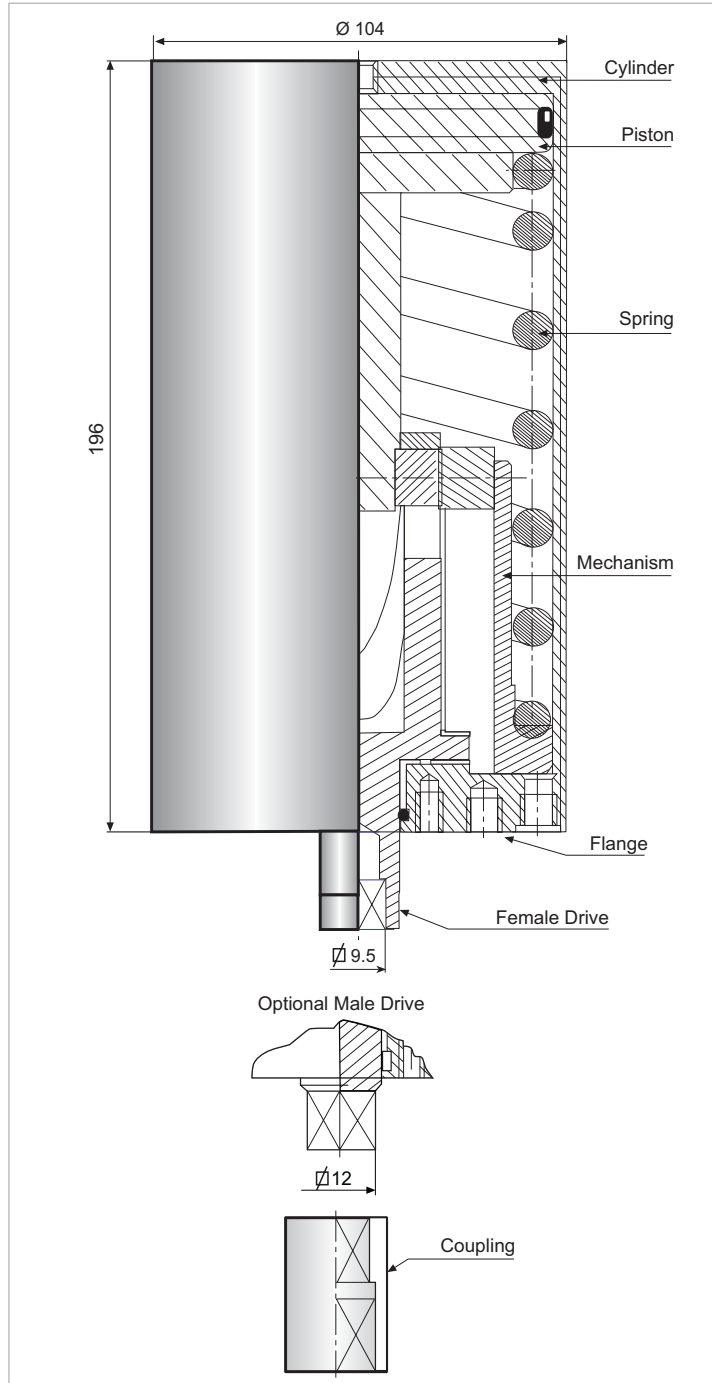

**MIDI BUTTERFLY VALVE ACTUATOR**

Ordering Code	Size
EBA2W1D	3"-5"/DN 80-125

**MIDI BALL VALVE ACTUATOR**

Ordering Code	Size
EBA2W2D	2½"/DN 65

\* Detailed product brochure is available.



### \* PVE - INCH SINGLE SEAT VALVE

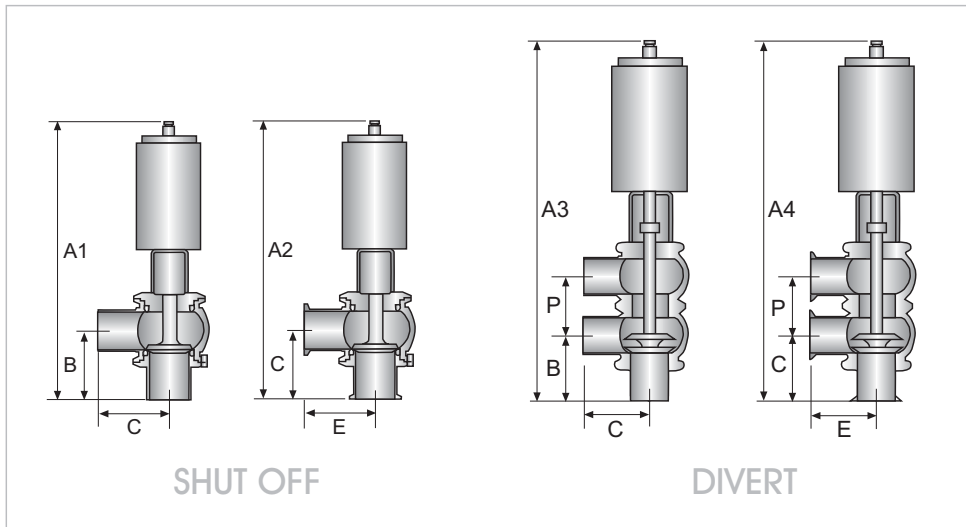

### PVE - INCH SHUT OFF VALVE

Ordering Code	Size
PVES1.517WE	1½"
PVES2.017WE	2"
PVES2.517WE	2½"
PVES3.017WE	3"

### PVE - INCH DIVERT VALVE

Ordering Code	Size
PVED1.517WE	1½"
PVED2.017WE	2"
PVED2.517WE	2½"
PVED3.017WE	3"

\* Available in EPDM, VITON<sup>®</sup> Gaskets.

\* Please specify Gasket material.

\* Detailed product brochure is available.

#### Dimensions

Size	A1	A2	A3	A4	B	C	E	P
1.5"	371	384	462	475	58	70	70	70
2"	396	408	494	506	77	89	89	80
2.5"	405	418	531	544	76	89	89	100
3"	463	477	616	630	83	95	95	120



### \* PVE - DIN SINGLE SEAT VALVE

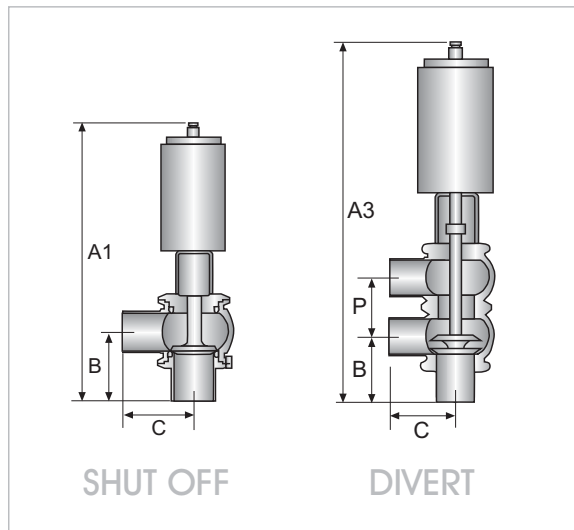

### PVE - DIN SHUT OFF VALVE

Ordering Code	Size
PVES4017WE	DN 40
PVES5017WE	DN 50
PVES6517WE	DN 65
PVES8017WE	DN 80

### PVE - DIN DIVERT VALVE

Ordering Code	Size
PVED40177WE	DN 40
PVED50177WE	DN 50
PVED65177WE	DN 65
PVED80177WE	DN 80

\* Available in EPDM, VITON® Gaskets.

\* Please specify Gasket material.

\* Detailed product brochure is available.

### Dimensions

DN	A1	A3	B	C	P
40	377	465	63	90	70
50	398	486	71	92	80
65	416	536	87	125	100
80	473	618	93	125	120



### EGMO SAMPLING VALVES (ESV)

**ESV 1** Fail-safe design for pharmaceutical, bio-chemical, cosmetic, food and dairy industries. Applications with SIP/CIP sterilization port.

**ESV 2** Fail-safe design for pharmaceutical, bio-chemical, cosmetic, food and dairy industries.

**ESV 3** Fail-safe design for general applications in the dairy, food, winery, breweries and beverage industries.

**ESV 4** Reactors & vessels bottom. Fail-safe design for pharmaceutical, bio-chemical and cosmetic industries applications.

**ESV 5** Weld / in-line type general applications for dairy, food, winery, breweries and beverage industries.

**ESV 6** Weld / in-line type general applications for dairy, food, winery, breweries and beverage industries with CIP sterilization port.



### CHECK VALVE - DIN - WELDING ENDS

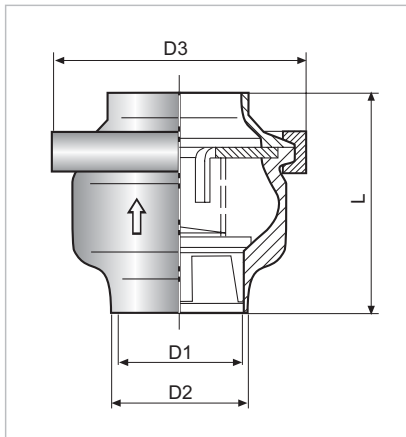

Ordering Code	Size	Dimensions				
		D1	D2	D3	L	Weight (Kg)
VRD025-WW	DN25	26	31	64	72	0.58
VRD032-WW	DN32	32	37	77	72	0.86
VRD040-WW	DN40	38	43	91	80	1.17
VRD050-WW	DN50	50	55	104	90	1.55
VRD065-WW	DN65	66	72	119	105	2.80
VRD080-WW	DN80	81	87	145	125	3.96
VRD100-WW	DN100	100	106	170	140	6.50

### CHECK VALVE - INCH - WELDING ENDS

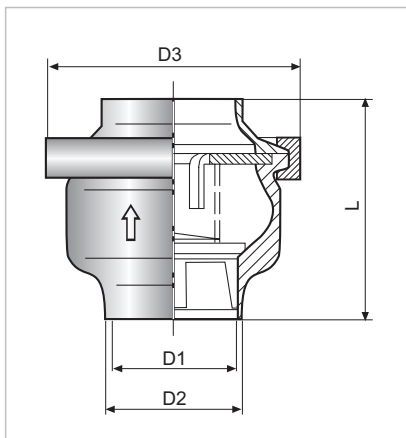

Ordering Code	Size	Dimensions				
		D1	D2	D3	L	Weight (Kg)
VRR1.0-WW	1"	26	31	64	72	0.58
VRR1.5-WW	1½"	38	43	91	80	1.17
VRR2.0-WW	2"	50	55	104	90	1.55
VRR2.5-WW	2½"	66	72	119	105	2.80
VRR3.0-WW	3"	81	87	145	125	3.96
VRR4.0-WW	4"	100	106	170	140	6.50

### THROTTLE VALVE

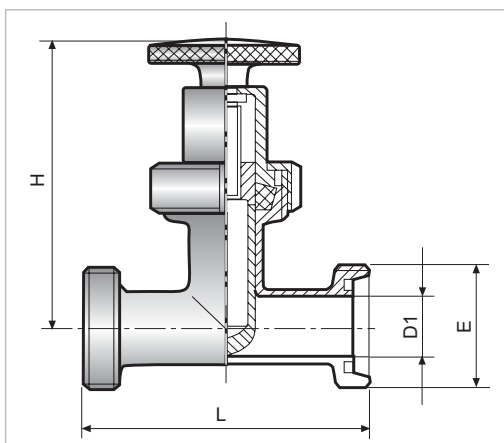

Ordering Code	Size	Dimensions				
		D1	D2	L1	L2	Weight (Kg)
VRT1.0-22	1"	22.9	28	96	70	0.72
VRT1.5-22	1½"	35.1	41	110	70	1.12
VRT2.0-22	2"	47.8	54	110	70	1.38
VRT2.5-22	2½"	60.5	68	124	85	1.90
VRT3.0-22	3"	72.1	78	132	85	2.35
VRT4.0-22	4"	97.6	104	167	115	2.80



### CHECK VALVE - DIN - BTW. FLANGES

Ordering Code	Size	Dimensions					Weight (Kg)
		D1	D2	D3	L1	L2	
VRD025-IWW	DN25	26	31	87	90	50	1.90
VRD032-IWW	DN32	32	37	92	90	50	1.92
VRD040-IWW	DN40	38	43	97	105	55	2.08
VRD050-IWW	DN50	50	55	110	114	64	2.72
VRD065-IWW	DN65	66	72	127	125	75	3.38
VRD080-IWW	DB80	81	87	142	150	90	7.72
VRD100-IWW	DN100	100	106	162	160	100	10.20

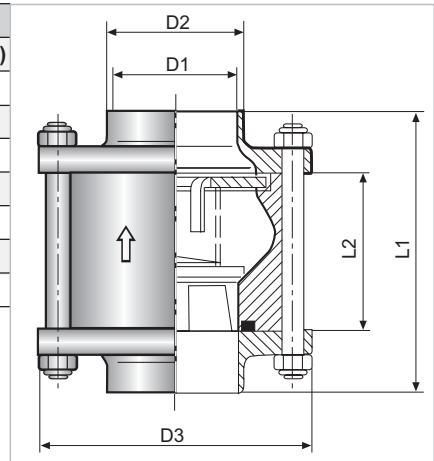

### CHECK VALVE - INCH - BTW. FLANGES

Ordering Code	Size	Dimensions					Weight (Kg)
		D1	D2	D3	L1	L2	
VRR1.0-IWW	1"	22.9	28	87	90	50	1.90
VRR1.5-IWW	1½"	35.1	41	97	105	55	2.08
VRR2.0-IWW	2"	47.8	54	110	114	64	2.72
VRR2.5-IWW	2½"	60.5	68	127	125	75	3.38
VRR3.0-IWW	3"	72.1	78	142	150	90	7.72
VRR4.0-IWW	4"	97.6	104	162	160	100	10.20

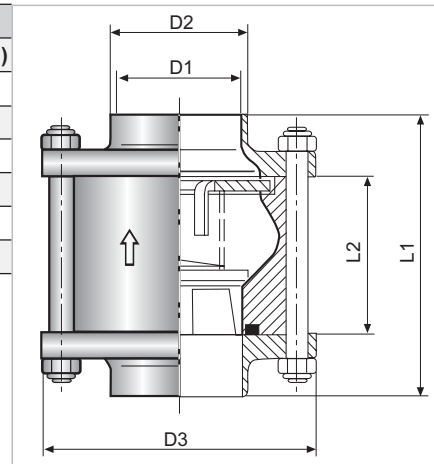

### VENT VALVE

Ordering Code	Dimensions					
	D1	D2	D3	A	H1	H2
VC	Ø 19 X 1½	Ø 54	Ø 12 X 1	53	122	77

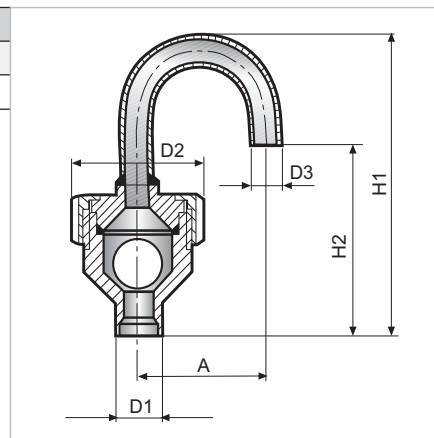





**Neumo Ehrenberg Group**

Sanitary Stainless Steel

# Accessories

**EGMO** designs, engineers, and manufactures a complete line of sanitary stainless steel accessories including:

- \* Strainers
- \* Sight glasses
- \* Pipe supports
- \* Customized components





### SIGHT GLASS - DIN - WELD ENDS

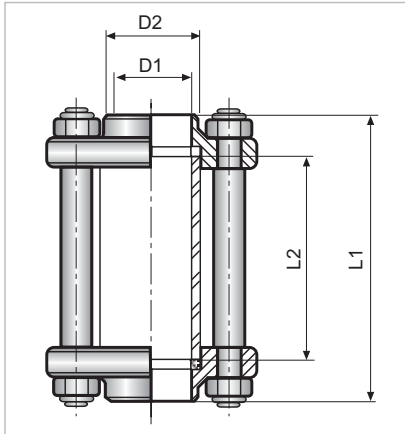

Ordering Code	Size	Dimensions				Weight (Kg)
		D1	D2	L1	L2	
FSD010-I023	DN10	10	15	88	60	0.25
FSD015-I023	DN15	16	21	88	60	0.30
FSD020-I023	DN20	20	25	88	60	0.73
FSD025-I023	DN25	26	31	98	70	0.75
FSD032-I023	DN32	32	37	104	70	0.76
FSD040-I023	DN40	38	43	112	70	1.08
FSD050-I023	DN50	50	55	112	70	1.34
FSD065-I023	DN65	66	72	127	85	1.90
FSD080-I023	DN80	81	87	135	85	2.35
FSD100-I023	DN100	100	106	169	115	2.80

### SIGHT GLASS - INCH - WELD ENDS

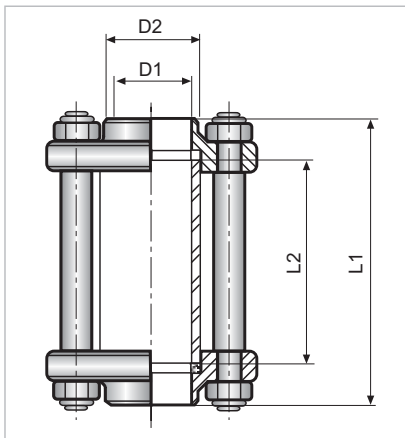

Ordering Code	Size	Dimensions				Weight (Kg)
		D1	D2	L1	L2	
FSR1.0-I023	1"	22.9	28	96	70	0.72
FSR1.5-I023	1½"	35.1	41	110	70	1.12
FSR2.0-I023	2"	47.8	54	110	70	1.38
FSR2.5-I023	2½"	60.5	68	124	85	1.90
FSR3.0-I023	3"	72.1	78	132	85	2.35
FSR4.0-I023	4"	97.6	104	167	115	2.80

### CYLINDER FOR SIGHT GLASS

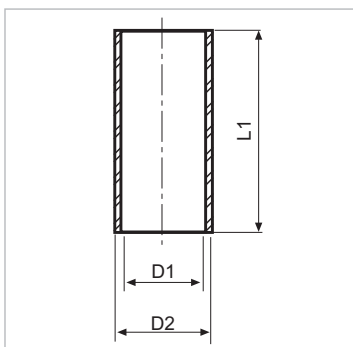

Ordering Code	Size	Dimensions				Weight (Kg)
		D1	D2	L1	L2	
FSD025-I1	1"	26	32	70	70	0.04
FSD040-I1	1½"	40	50	70	70	0.11
FSD050-I1	2"	50	60	70	70	0.14
FSD070-I1	2½"	60	70	85	85	0.18
FSD085-I1	3"	75	85	90	85	0.27
FSD104-I1	4"	100	110	115	115	0.43

### SEAL RING FOR SIGHT GLASS - EPDM

Ordering Code	Size	Dimensions				Weight (Kg)
		D1	D2	L1	L2	
FSR1.0-I2	1"	26	33	3	70	0.72
FSR1.5-I2	1½"	38	51	3	70	1.12
FSR2.0-I2	2"	50	61	3	70	1.38
FSR2.5-I2	2½"	61	72	3	85	1.90
FSR3.0-I2	3"	76	87	4	85	2.35
FSR4.0-I2	4"	100	111	4	115	2.80

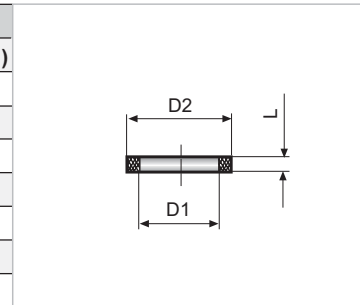

### PERFORATED PLATE SAFETY SCREEN

Ordering Code	Size	Dimensions				Weight (Kg)
		D1	D2	L1	L2	
FSD025-I3	1"	34	36	96	70	0.01
FSD040-I3	1½"	52	54	110	70	0.02
FSD050-I3	2"	63	65	110	70	0.03
FSD070-I3	2½"	78	80	124	85	0.04
FSD085-I3	3"	94	96	132	85	0.04
FSD104-I3	4"	113	115	167	115	0.07

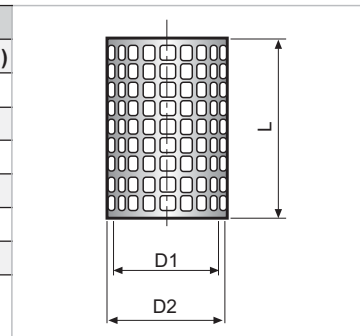

### POLYCARBONATE SAFETY SCREEN

Ordering Code	Size	Dimensions				Weight (Kg)
		D1	D2	L1	L2	
FSD025-I4	1"	22.9	28	96	70	0.72
FSD040-I4	1½"	35.1	41	110	70	1.12
FSD050-I4	2"	47.8	54	110	70	1.38
FSD070-I4	2½"	60.5	68	124	85	1.90
FSD085-I4	3"	72.1	78	132	85	2.35
FSD104-I4	4"	97.6	104	167	115	2.80

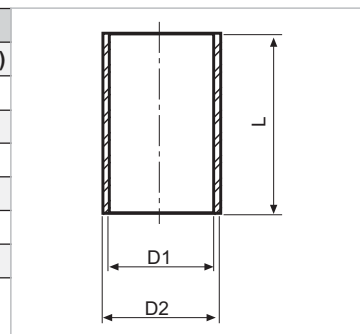



### BS ANGLE TYPE STRAINER

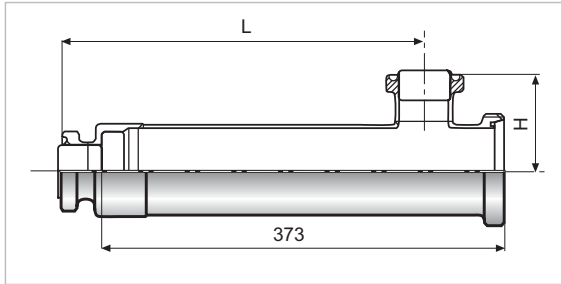

Ordering Code	Size	Dimensions	
		L	H
FSR1.0-D	1"	347.5	72.5
FSR1.5-D	1½"	347.5	72.5
FSR2.0-D	2"	347.5	98.5
FSR2.5-D	2½"	347.5	102
FSR3.0-D	3"	347.5	102

### DIN ANGLE TYPE STRAINER

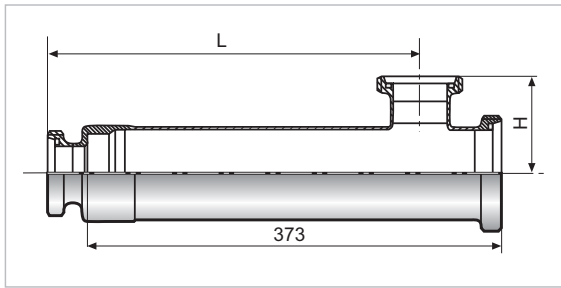

Ordering Code	Size	Dimensions	
		L	H
FSD025-D	DN 25	342	80
FSD040-D	DN 40	342	80
FSD050-D	DN 50	343	84
FSD065-D	DN 65	345	99

### INSERT FOR ANGLE TYPE STRAINER

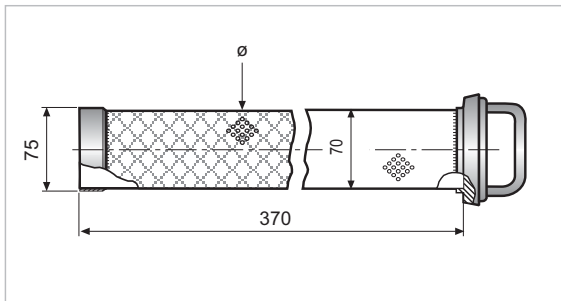

Ordering Code	Size	Dimensions
		ø
FS-0.6-D05	1"-3"/DN25-65	0.6 mm
FS-0.8-D05	1"-3"/DN25-65	0.8 mm
FS-1.0-D05	1"-3"/DN25-65	1.0 mm
FS-1.5-D05	1"-3"/DN25-65	1.5 mm
FS-2.0-D05	1"-3"/DN25-65	2.0 mm
FS-3.0-D05	1"-3"/DN25-65	3.0 mm
FS-5.0-D05	1"-3"/DN25-65	5.0 mm



### INCH PIPE SUPPORT

Ordering Code	Size	Dimensions		
		D1	M	S
FSR1.0-S	1"	25.4	M-6	3
FSR1.5-S	1½"	38.1	M-6	3
FSR2.0-S	2"	50.8	M-6	3
FSR2.5-S	2½"	63.5	M-6	3
FSR3.0-S	3"	76.2	M-6	3
FSR4.0-S	4"	101.6	M-6	3

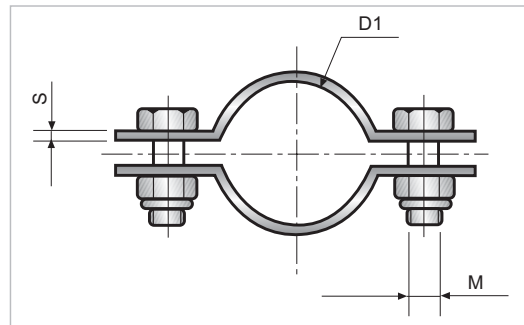

### DIN PIPE SUPPORT

Ordering Code	Size	Dimensions		
		D1	M	S
FSD025-S	DN 25	28	M6	3
FSD032-S	DN 32	34	M6	3
FSD040-S	DN 40	40	M6	3
FSD050-S	DN 50	52	M6	3
FSD065-S	DN 65	70	M6	3
FSD080-S	DN 80	85	M6	3
FSD100-S	DN 100	104	M6	3

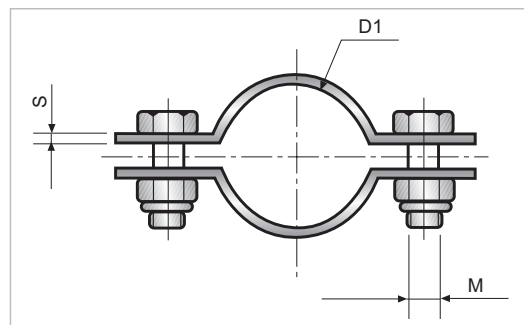

EGMO offers a wide range of pipe support.

\* For more detailed information please request our full pipe support catalogue.



### Egmo Customized Components For Dairy & Food Industry

EGMO specializes in manufacturing customized stainless steel components and sub-assemblies from customer specifications, sketches or drawings.





### Chemical Composition for Various Stainless Steels

AISI	DIN	C	Cr	Ni	Mo
304	1.4301	0.07	17.0-19.0	8.5-10.5	-
304L	1.4306	0.03	18.0-20.0	10.0-12.5	-
316	1.4401	0.07	16.5-18.5	10.5-13.5	2.0-2.5
316L	1.4404	0.03	16.0-18.5	11.0-14.0	2.0-2.5

### Conversion Table for Surface Roughness

Mechanical Finish		
μ"	μm	Grit
32 Ra	0.8 Ra	150
25 Ra	0.6 Ra	180
20 Ra	0.5 Ra	240
12 Ra	0.3 Ra	320

### Gasket Material Properties

Property	EPDM	PTFE®	BUNA-N	VITON®	SILICON
Temperature range	-55 to 275° F -48 to 135° C	-40 to 450° F -40 to 232° C	-40 to 225° F -40 to 107° C	-20 to 400° F -29 to 204° C	-80 to 450° F -62 to 232° C
Acid resistance	Good - excellent	Excellent	Good	Good	Good
Alkali resistance	Good - excellent	Excellent	Fair - Good	Poor - good	Poor - fair
Petroleum oil resistance	Poor	Excellent	Excellent	Excellent	Good
Vegetable oil resistance	Good	Excellent	Good	Excellent	Good
Abrasion resistance	Good - excellent	Excellent	Good	Good	Good - excellent
Compression set	Fair	Cold flows	Good	Good - excellent	Good - excellent

### Pressure Service Ratings for Sanitary Stainless Steel Clamps

Size Tube OD	13MHHM				13MHMD				13MHHM-H			
	@70°F / 21°C		@250°F / 121°C		@70°F / 21°C		@250°F / 121°C		@70°F / 21°C		@250°F / 121°C	
	PSI	bar	PSI	bar	PSI	bar	PSI	bar	PSI	bar	PSI	bar
½" & ¾"	1500	103	1200	83					1500	103	1200	83
1 & 1½"	500	34	250	17	500	34	250	17	500	34	250	17
2"	450	31	250	17	450	31	250	17	450	31	250	17
2½"	400	28	200	14	400	28	200	14	400	28	200	14
3"	350	24	150	10	350	24	150	10	350	24	150	10
4"	200	14	125	9	200	14	125	9	200	14	125	9
5"	175	12	100	7					175	12	100	7
6"	150	10	75	5					150	10	75	5
8"	100	7	50	3					100	7	50	3
10"	40	3	30	2					40	3	30	2
12"	30	2	25	2					30	2	25	2



### Friction Loss Equivalent In M Straight Stainless Steel Pipe For One Item

Item	Nominal Diam.					
	25.4 mm	38.1 mm	50.8 mm	63.5 mm	76.2 mm	101.6 mm
Single seat valve	6	8	8	9	10	10
Divert valve	7	9	9	10	12	12
Elbow	0.8	1	1	1	1	1.5
Tee	2	3	3	4	5	5

The pressure loss figures give close approximations for liquids having viscosities below 5 cPs, such as water, whole milk etc.

### Velocity in Stainless Steel Pipes

Product	Ø 25.4 mm	Ø 101.6 mm	Ø 25.4 mm	Ø 101.6 mm
Milk	1.5	2.0	2.0	2.5
Water	3.0	3.0	3.0	3.5
Cream	1.5	1.5	2.0	2.0

- For CIP cleaning, the velocity should not be less than 1.5m/sec.
- The velocity in stainless steel pipes should not exceed the values stated below ( in m/sec.):

### Volume in Stainless Steel Pipes

Outside Diameter	Inside Diameter	Lit. / meter
25.4 mm	22.6 mm	0.40
38.1 mm	35.6 mm	0.99
50.8 mm	48.6 mm	1.85
63.5 mm	60.3 mm	2.85
76.2 mm	72.9 mm	4.17
101.6 mm	97.6 mm	7.48





**Operating Pressures of Stainless Steel Tubing**

Size OD Tube	Nom. Wall	AISI 316L (1.4404)			AISI 304L (1.4306)		
		Working Pressure (psi/bar)	Yield Pressure (psi/bar)	Burst Pressure (psi/bar)	Working Pressure (psi/bar)	Yield Pressure (psi/bar)	Burst Pressure (psi/bar)
1/2"	.065	4.550/314	6.500/448	18.200/1.255	4.880/336	7.800/538	19.500/1.344
3/4"	.065	3.030/209	4.300/296	12.100/834	3.250/224	5.200/358	13.000/896
1"	.065	2.280/157	3.300/227	9.100/627	2.440/168	3.900/269	9.800/896
1 1/2"	.065	1.520/105	2.200/152	6.100/421	1.630/112	2.600/179	6.500/448
2"	.065	1.140/79	1.600/110	4.600/317	1.220/84	2.000/138	4.900/338
2 1/2"	.065	910/63	1.300/90	3.600/248	980/68	1.600/110	3.900/269
3"	.065	760/52	1.100/76	3.000/207	810/56	1.300/90	3.300/228
4"	.083	730/50	1.000/69	2.900/200	780/54	1.200/83	3.100/214
6"	.109	640/44	900/62	2.500/172	680/47	1.100/76	2.700/186
8"	.109	480/33	680/47	1.900/131	510/35	820/57	2.000/138
10"	.134	470/32	670/46	1.900/131	500/34	800/55	2.000/138

**Comparison of Tolerances for Welded and Seamless Tubs**

Size OD Tube	Nom. Wall	A S T M - A 2 6 9			A S T M - A 2 7 0		
		O.D.	Wall Thickness	Ovality Allowance	O.D.	Wall Thickness	Ovality Allowance
1/2"	.065	±.005	±.006	0	-	-	-
3/4"	.065	±.005	±.006	.020	-	-	-
1"	.065	±.005	±.006	.020	+.002/- .008	±.008	0
1 1/2"	.065	±.010	±.006	.040	+.002/- .008	±.008	0
2"	.065	±.010	±.006	.040	+.002/- .011	±.008	0
2 1/2"	.065	±.010	±.006	.040	+.002/- .011	±.008	.050
3"	.065	±.010	±.006	.040	+.003/- .012	±.008	.060
4"	.083	±.015	±.008	.060	+.003/- .015	±.010	.080
6"	.109	±.030	±.010	.120	-	-	-
8"	.109	±.030	±.010	.120	-	-	-

**Standard Tube Sizes**

D N	Tubes by DIN 11850			Old Dimensions	DIN EN ISO 1127	ISO 2037 BS 4825 Part 1		ASTM A 269/270	
	1	2	3						
10	12 x 1.0	13 x 1.5	14 x 2.0	12 x 1.5	17.2 x 1.6			1/8"	3.30 X 0.25
15	18 x 1.0	19 x 1.5	20 x 2.0	18 x 1.5	21.3 x 1.6			1/4"	6.35 X 0.25
20	22 x 1.0	23 x 1.5	24 x 2.0	22 x 1.5	26.9 x 1.6	1/2"	12.7 x 1.65	1/2"	12.7 X 1.65
25	28 x 1.0	29 x 1.5	30 x 2.0	28 x 1.5	33.7 x 2.0	3/4"	19.05 x 1.65	3/4"	19.05 X 1.65
32	34 x 1.0	35 x 1.5	36 x 2.0	34 x 1.5	42.4 x 2.0	1"	25.4 x 1.6	1"	25.4 X 1.65
40	40 x 1.0	41 x 1.5	42 x 2.0	40 x 1.5	48.3 x 2.0	1 1/4"	31.8 x 1.6	1 1/2"	38.1 X 1.65
50	52 x 1.0	53 x 1.5	54 x 2.0	52 x 1.5	60.3 x 2.0	1 1/2"	38 x 1.6	2"	50.8 X 1.65
65		70 x 2.0			76.1 x 2.3	2"	51 x 1.6	2 1/2"	63.5 X 1.65
80		85 x 2.0			88.9 x 2.3	2 1/2"	63.5 x 1.6	3"	76.2 X 1.65
100		104 x 2.0			114.3 x 2.6	3"	76.1 x 1.6	4"	101.6 X 2.0
125		129 x 2.0			139.7 x 2.6	4"	101.6 x 2.0		
150		154 x 2.0			168.3 x 2.6				
200		200 x 2.0			219.1 x 2.6				

\* Dimensions in mm.

TECHNICAL INFORMATION



### Values for Flow Speed

Material	Product	Form of use	Flow speed m/s
WATER	Drinking water	Soaking line	Up to 1.5
		Pressure line	2.0
	Line water	Soaking pressure	1.5
		Pressure line	2.0
	Warm water	Recycling in closed line	3.0
	Ice water	Soaking line	1.3
		Pressure line	2.5
	Retour water	Soaking line	1.5
		Pressure line	3.0
	COOLING MEDIA	Ammonia	Liquid line
Gas line			1.5-20
AIR	Pressed air	Soaking line	6
	Sterile air	Pressure line	15
CLEANING MEDIA		Soaking line	1.5
		Pressure line	2.0
	Milk	Soaking line	1.0-2.0
		Pressure line	2.0-3.0
	Cream	Soaking line	0.7-1.0
		Pressure line	1.0-2.0
	Yogurt	Soaking line	0.5-0.8
		Pressure line	1.0-1.5
	Soft drinks	Soaking line	0.5-1.0
		Pressure line	1.2-2.0

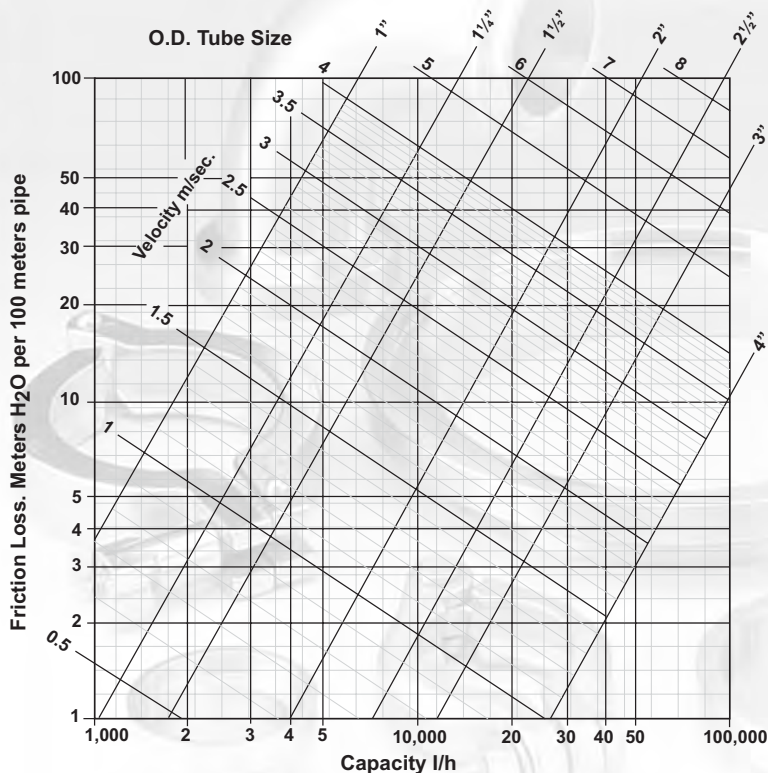

### Capacity, friction loss and velocity of flow stainless steel pips

**Example:** 10,000 l/h in 2" stainless steel pipe.

**Velocity:** 1.5 m/sec.

**Friction loss:** 5.5 m H<sub>2</sub>O per 100 m pipe.

When pipe dimensions are determined, the water velocity must not exceed 3 m/sec., and the milk and cream velocities must not exceed 1.5 m/sec. in the suction line and 2 m/sec. in the pressure line.

For CIP cleaning, the velocity should be at least 1.5 m/sec.

# Neumo Ehrenberg Group

Sanitary Stainless Steel



## The Neumo Ehrenberg Group - Global Locations



# Neumo Ehrenberg Group

NEUMO - EGMO - AWH - RIEGER - VNE - HERRLI



**EGMO**, founded in 1965, develops, designs, manufactures and markets a wide range of Stainless Steel tube fittings, valves and vessels.

**EGMO** uses advanced production methods in its 10,000 sq.m. plant in the north of Israel and this, together with its wide experience, guarantees superior quality products.

**EGMO** has an established reputation in the semiconductor, pharmaceutical, bio-chemical and food industries.

**EGMO** is ISO 9001:2000 certified, and its products also meet the following standards:

- TÜV
- ASME BPE
- 3A
- DIN
- ISO
- SMS
- BS / RJT

Innovation, Reliability and Service combined with top quality products are what EGMO offers its clients, and it is this that has earned EGMO its world-wide reputation. We at EGMO, invite you to view our catalog and to contact us at our offices for further information regarding our products.

## Main Products:

- Tubular fittings
- Clamp fittings
- Screwed pipe joints
- Adapters
- Butterfly valves
- Single seat valves
- Sample valves
- Actuators pneumatic and air operated
- Customized components
- Stainless Steel tubes and raw material

## Planning & Building Operations include:

- Custom designed process systems for the pharmaceutical, bio-chemical, food and other industries.
- Stainless Steel vessels in all sizes and types, up to 70,000 liters.
- Heat exchangers
- Planning and building production systems requiring Stainless Steel tubing
- Machinery layout and assembly of Stainless Steel installations

### EGMO Ltd. - Head Office:

P.O.B. 1111 Nahariya 22110, Israel  
Tel: +972 (0)4 9855 130 Fax: +972 (0)4 9855 175  
E-Mail: [markt@egmo.co.il](mailto:markt@egmo.co.il) Web: [www.egmo.co.il](http://www.egmo.co.il)

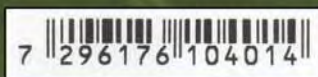

E024EE  
03/2007  
Edition:2

